

AMERICAN ASSOCIATION *for* STATE *and* LOCAL HISTORY

INSITE  
GUIDE

AASLH 2018  
ANNUAL MEETING

TRUTH  
*OR*  
CONSEQUENCES

SEPTEMBER 26-29



KANSAS CITY, MO



THE NATIONAL  
WWI MUSEUM  
AND MEMORIAL

# 65 MILLION PEOPLE SERVED IN WORLD WAR I.

EACH YEAR, 500,000 PEOPLE REMEMBER THEM HERE. The world's most comprehensive WWI collection is Kansas City's foremost visitor destination.

**No. 1 attraction**  
in Kansas City  
*TripAdvisor*

One of the  
**Top 5 Museums**  
in the country

*Yelp*

**theworldwar.org**  
816.888.8100



# WELCOME 2018 CONFERENCE PARTICIPANTS!

Union Station

Let me welcome you to an exciting four days of exploration across dozens of sessions and events, many of which will tackle *Truth or Consequences* in the work of public history.

We history practitioners show our commitment every day to accuracy, to reliable evidence, and, yes, to trying to tell the truth. In your own approach to the past, you certainly face history's multiple perspectives, diverse sources, shifting interpretations, and emergent new considerations. And still, at the end of the day, we all attempt to know how things actually happened. We understand that an idea is a fact until it is disproven. Without such a shared understanding of how knowledge is built, things fall apart.

Fortunately for our time together in Kansas City, you're going to be amazed by how well things hold together! Our Program Committee Chair Tim Grove and Host Committee Co-chairs Mindi Love and Matthew Naylor have led their committees in generating a great conference experience for you this week. We hope you will enjoy the many formats for discussion and meeting people. I can't do enough of it justice in this space, so I would urge you to have a quick look at the Schedule-at-a-Glance section and to dive into your 2018 Annual Meeting.

Onward!

John R. Dichtl  
President & CEO  
AASLH

## CONTENTS

- 3 Welcome from the Chairs
  - 4 Meeting Highlights/Need to Know
  - 5 Session Updates
  - 7 Featured Speakers
  - 9 Meeting Sponsors
  - 10 Schedule at a Glance
  - 13 NCPH Poster Session
  - 14 Floor Plans/Maps
- 
- 16 Exhibit Hall Highlights
  - 17 Exhibitors List/Floor Plan
  - 24 Tours
  - 27 Special Events
- 
- 28 Wednesday, September 26
  - 30 Thursday, September 27
  - 36 Friday, September 28
  - 42 Saturday, September 29
- 
- 45 Special Thanks
  - 46 AASLH Partners
  - 48 Award Winners
  - 49 Scholarship Winners

# Welcome to Freedom's Frontier National Heritage Area!



When you're in the greater Kansas City metro, you're in **Freedom's Frontier National Heritage Area**. And if you signed up for any conference tours, you'll explore some of the many historic sites in the bi-state, 41-county heritage area that partner with us to tell the stories of the shaping of the frontier, the Missouri-Kansas Border War, and the enduring struggle for freedom.

- Tag us on social media with a selfie, photo, or comment about your visit. **#FreedomFrontier**
- Find a historic timeline and "Places to See" on our webpage.
- Request a heritage area map.
- Come back with your family and friends!

[www.FreedomsFrontier.org](http://www.FreedomsFrontier.org)

PO Box 526  
200 W 9th Street  
Lawrence, KS 66044  
(785) 856-5300

Freedom's  
Frontier  
NATIONAL HERITAGE AREA



**“If you tell the unvarnished truth, people will be changed.”**

—John Hope Franklin

**“A well-organized society is one in which we know the truth about ourselves collectively, not one in which we tell pleasant lies about ourselves.”**

—Tony Judt

**“In a democracy, history thrives on a passion for knowing the truth.”**

—*Telling the Truth About History*

**W**elcome to Kansas City and #AASLH18!

On behalf of the program and host committees, we are so glad you have decided to join us for a few days of thought-provoking conversation, old friends, new friends, interesting historic sites, BBQ, music, and sharing each other's successes and challenges.

This year's theme, *Truth or Consequences*, gets at the heart of our discipline and allows us to ponder some difficult questions. In many ways, our profession has never been more relevant as our society asks “What is truth?” and “Who can we trust?” As we strive to tell the whole truth, to teach critical thinking, and to articulate why history is relevant, we can learn from each other.

The program and host committees have worked very hard to put together a conference that revolves around the theme. We hope that whether this is your first AASLH conference or your twentieth, you will take advantage of all this region has to offer and will leave professionally refreshed, with new ideas and perspectives, and an excitement about what we are accomplishing as we endeavor to make history accessible in so many ways to our various audiences.

Sincerely,

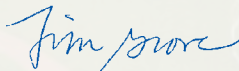

Tim Grove, 2018 Program Chair  
Grove History Consulting



Mindi Love, 2018 Host Co-Chair  
Johnson County Museum



Matthew C. Naylor, PhD, 2018 Host Co-Chair  
National World War I Museum and Memorial

STATE and LOCAL HISTORY

AASLH  
AMERICAN ASSOCIATION for STATE and LOCAL HISTORY

# MEETING HIGHLIGHTS

## AASLH Registration Desk Hours

The AASLH Annual Meeting registration desk is located in the Lobby 3500 of the Convention Center. The desk will be staffed during the following times to answer any questions you may have during the meeting.

<b>Tuesday, September 25</b>	<b>3–5 pm</b>
<b>Wednesday, September 26</b>	<b>7 am–6 pm</b>
<b>Thursday, September 27</b>	<b>7 am–6 pm</b>
<b>Friday, September 28</b>	<b>7 am–5 pm</b>
<b>Saturday, September 29</b>	<b>8 am–12 pm</b>



## Need to Know!

- Name badges must be worn at all times.**
- Only registered attendees will be allowed to attend sessions and workshops.
- Nonregistered guests** are not allowed to attend sessions or workshops, but **may purchase tickets to attend tours and other special events.** Please check with AASLH registration desk for availability.
- Your purchased tickets** are located in your **registration packet.** Please check them for the appropriate meeting times and locations for special events.
- Tickets are necessary for all workshops, labs, luncheons, tours, and evening events.** Please show your ticket before boarding buses or entering an evening event. If you'd like to purchase tickets, please visit the AASLH registration desk. Some events may be sold out.

## POP UP ROUNDTABLES!

Is your head buzzing with a current issue or question that is relevant to the field? Is there something you just want to talk about with your colleagues? We have held two slots during the conference for roundtable discussions about a subject you don't see represented in the current meeting schedule. THESE SESSIONS ARE NOT PRESENTATIONS—they are facilitated discussions. To propose a topic, visit the conference registration desk before 2 pm on Thursday. You can also visit the desk to vote for a proposed topic. We'll announce the session topics by 6 pm on Thursday (via Twitter and on the information board), and they'll be held during the following sessions Friday at 8:30 am and Saturday at 9 am.

## SHARING YOUR IDEAS AND OPPORTUNITIES

The AASLH Annual Meeting includes activities and networking especially for the field of state and local history! In addition to sponsored sessions throughout the meeting, you're invited to attend the following AASLH Affinity Group events to discuss the latest issues, share ideas, and to be inspired:

WEDNESDAY	THURSDAY		FRIDAY
Business History Tour	Diversity and Inclusion Task Force Mixer	Legal History Tour	Military History Breakfast
Diversity and Inclusion Task Force Workshop	Educators and Interpreters Lunch	Religious History Lunch	
Field Services Alliance Meeting	Historic House Museums Breakfast	Small Museums Lunch	StEPs Morning Meet Up
	History Leadership Institute Reception	Women's History Lunch	

**#AASLH18 App:** Download the #AASLH18 conference app to plan and manage your schedule, preview speaker and attendee profiles, browse exhibitor listings, and access conference center maps, all from your mobile device. To download the app, search “Attendify App” in the Apple App Store or Google Play Store and download. Within the Attendify app, search “**AASLH**” and click “Join” to add the #AASLH18 conference. You will be prompted to create a profile with your first name, last name, and email address. Please note that no emails other than a confirmation will be sent to that address. You can also find download instructions online at [aaslh.org/conference](http://aaslh.org/conference).

### History Happy Hours

Take a few moments for some informal networking with colleagues. Many of our affinity groups will be hosting informal meet-ups in the hotel or at local watering holes where you can come together and meet people with similar professional interests. Food and drinks are not provided, but good conversation and connections are free. See the Registration Desk for a map and directions.

#### THURSDAY, SEPTEMBER 27

5:30–6:30 pm

#### Business History Networking Meet Up

► *BRGR Kitchen & Bar*

7–8:30 pm

#### Emerging History Professionals Networking Meet Up

► *The Chesterfield Bar*

### Session Updates

#### Cancellations

The tour **Westport: Gateway to the Missouri-Kansas Border Region’s “Hinges of History”** on Friday at 1:30 pm has been cancelled.

The tour **The Struggle for Kansas Statehood** on Saturday at 1:30 pm has been cancelled.

#### Friday Session Name Changed

The session **Moving Past Stereotypes and Myths: Improving Women’s Interpretation at Historic Sites and Museums** on Friday at 12:30 pm is now **Beyond “Slave” and “Mistress”: Improving Women’s Interpretation at Historic Sites and Museums**.

#### Friday Session Added

The session **Civil Rights Beyond the South: The Significance of Missouri in the Black Freedom Struggles of the 1960s** has been added to Friday at 8:30–9:45 am.

#### Friday Session Moved

The session **The Truth about Troost: The Consequences of Engaging Diverse Students in Conversations about Race Based on Local History** has been moved to Friday at 12:30–1:45 pm.



### Social Media

Share your photos and comments about the conference on LinkedIn, Facebook, or Twitter. Use hashtag **#AASLH18**.

### Reduce, Reuse, Recycle

Please help keep our meeting environmentally-friendly by placing items in the correct recycling containers placed throughout the Convention Center.

### Sessions and Annual Meeting Evaluations

Help us improve! Session evaluations are placed in each meeting room. Please take a few minutes to complete the form at the end of the session. An overall Annual Meeting evaluation will be emailed after the meeting.

# STRUGGLE FOR MISSOURI'S STATEHOOD

BICENTENNIAL TRAVELLING EXHIBIT

*Struggle for Statehood* is a travelling exhibit chronicling the three years in which the controversy over Missouri's admission into the Union was fiercely debated.

It is scheduled to go on display in December of this year and tour around the state until December 2021.

For questions or to request this exhibit, go to [www.mohumanities.org](http://www.mohumanities.org).

 Kinder Institute on  
Constitutional Democracy  
University of Missouri

 MISSOURI  
HUMANITIES



# FEATURED SPEAKERS

## THURSDAY, SEPTEMBER 27

8:30–9:45 am

**Dan Snow** is a historian and British television personality who presents history programs for the BBC and other broadcasters, has a history slot on *The One Show*, and hosts the podcast *Dan Snow's History Hit*, which also includes a video version on YouTube. According to his biography on the BBC, Dan believes that “History is the most exciting thing that has ever happened to anyone on this planet.” Born and raised in London, he remembers spending every weekend of his childhood being taken to castles, battlefields, country houses, and churches. Dan developed a great love of history which he went on to pursue at Oxford University. After college, he started presenting military history programs with his father, Peter Snow. Their series, *Battlefield Britain*, won a BAFTA award. During the course of his work, Dan has flown World War II aircraft, been gassed, shoveled muck in a sewer under London for a day, contracted pneumonia, and been trained as a sniper.



## FRIDAY, SEPTEMBER 28

2–3:15 pm

**Cheryl Brown Henderson** is one of the three daughters of the late Rev. Oliver L. Brown who, in the fall of 1950 along with twelve other parents led by attorneys for the NAACP, filed suit on behalf of their children against the local Board of Education. Their case joined with cases from Delaware, South Carolina, Virginia, and Washington, D.C. on appeal to the U.S. Supreme Court and on May 17, 1954, became known as the landmark decision *Brown v. Board of Education of Topeka, Kansas*. Cheryl is the Founding President of the Brown Foundation for Educational Equity, Excellence, and Research, and owner of Brown & Associates educational consulting firm. She has extensive background in education, business, and civic leadership, having served on and chaired various local, state, and national boards. In addition, she has two decades of experience in political advocacy, public policy implementation, and federal legislative development. She is the recipient of various awards and recognition for work in education and community service; presentations at numerous conferences, conventions and universities; and for her work with Congress and the National Park Service to preserve sites associated with the landmark U.S. Supreme Court ruling of 1954.



Our latest project, the *Treasure Seekers* exhibit at the Tampa Bay History Center, an engaging multi-media 3-D experience featuring fixtures, interactive displays, fine woodworking, digital mapping and hologram projection.

Image: Seamus Payne



Intelligent **DESIGN**

Custom **BUILD**

Precision **INSTALL**

**Give us an  
empty gallery.  
We'll do the rest.**

Hospitality Corporate Museums Healthcare Libraries Education

Museum professionals know the secret to completing a complex creative endeavor, and that's to partner with a **Sole Source Provider**

Creative Arts is an artisan studio offering a comprehensive approach to service and a seamless experience. Concept to completion. Your vision is what we design. We build to your exact specifications. And we install the finished work with care and precision. Great exhibits custom made. Call us.



**Creative Arts**  
UNLIMITED INC.

Visit us at [creativeartsinc.com](http://creativeartsinc.com) or call 727.525.2066

2017 Award Winner for SEMC and Florida Association of Museums

**AASLH OFFICERS**

- Katherine Kane**, *Chair*  
Harriet Beecher Stowe Center
- John Fleming**, *Vice Chair*  
National Museum of African American Music
- Julie Rose**, *Immediate Past Chair*  
Homewood Museum
- Norman Burns, II**, *Treasurer*  
Conner Prairie
- Linnea Grim**, *Secretary*  
Thomas Jefferson's Monticello
- Erin Carlson Mast**, *Council's Representative*  
President Lincoln's Cottage

**AASLH COUNCIL**

- Bill Adair**, Class of 2018  
Pew Center for Arts & Heritage
- Melanie Adams**, Class of 2020  
Minnesota Historical Society
- Dina A. Bailey**, Class of 2018  
International Coalition of Sites of Conscience
- Marian Carpenter**, Class of 2019  
John and Mable Ringling Museum of Art
- Lisa Eriksen**, Class of 2021  
Lisa Eriksen Consulting
- Kim Fortney**, Class of 2020  
National History Day
- Leigh A. Grinstead**, Class of 2018  
LYRASIS
- Jennifer Kilmer**, Class of 2019  
Washington State Historical Society
- Stacy Klingler**, Class of 2021  
William Butterworth Foundation
- Nicola Longford**, Class of 2018  
The Sixth Floor Museum at Dealey Plaza
- Kyle McKoy**, Class of 2020  
Mercer Museum and Fonthill Castle
- Brent Ott**, Class of 2021  
The Henry Ford
- Sarah Pharaon**, Class of 2019  
International Coalition of Sites of Conscience

- Trina Nelson Thomas**, Class of 2021  
Stark Art & History Venues
- Scott Wands**, Class of 2020  
Connecticut Humanities

**STAFF**

- Aja Bain**  
Program and Publications Manager
- Cherie Cook**  
Senior Program Manager
- John R. Dichtl**  
President and CEO
- Natalie Flammia**  
Education and Service Manager
- Darah Fogarty**  
Marketing Manager
- Bethany L. Hawkins**  
Chief of Operations
- Terry Jackson**  
Membership and Database Manager
- John Garrison Marks**  
History News and Publications Editor  
Senior Manager, Strategic Initiatives

# ANNUAL MEETING SPONSORS

AASLH THANKS YOU!

**PREMIER SPONSOR**



**PLATINUM SPONSORS**



**GOLD SPONSORS**



**SCHOLARSHIP SPONSOR**

William T. Kemper Foundation

**SILVER SPONSORS**

- Barton P. and Mary D. Cohen Charitable Trust
- Collector Systems
- Heritage League of Greater Kansas City
- Jackson County Historical Society
- Johnson County Museum

**BRONZE SPONSOR**

Watkins Museum of History

**HEARTLAND SPONSORS**

- City of Shawnee-Shawnee Town 1929
- Historic Kansas City Foundation
- Kansas City Museum
- Mahaffie Stagecoach Stop and Farm
- Svadlenak Museum Consulting

**NETWORKING SPONSORS**

- Kansas State Historical Society
- Linda Hall Library of Science, Engineering, and Technology
- Midwest Center for Holocaust Education, Inc.
- Missouri Association for Museums and Archives
- National Council on Public History
- University of Missouri-Kansas City, History Department and Center for Midwestern Studies
- Westport Historical Society

**EVENING EVENT SPONSOR**

John Sherman and Marny Donnelly Sherman

# SCHEDULE AT A GLANCE

## TUESDAY, SEPTEMBER 25

3–5 pm REGISTRATION

## WEDNESDAY SEPTEMBER 26

7 am–6 pm REGISTRATION

### TOURS

8 am–5:30 pm

- President for a Day: Walk a Mile in Harry Truman's Shoes, Cost: \$70

8:30 am–5:30 pm

- The Truth about Lawrence, Kansas, Cost: \$70

8:30 am–12:30 pm

- Kansas City Treasures, Cost: \$38

1–5:30 pm

- Business History of Kansas City, Cost: \$38

1:30–5:30 pm

- Johnson County History: From Settlement to Suburbs, Cost: \$38

### MORNING WORKSHOPS

8:30 am–12 pm

- Donor-Focused Fundraising: Letting Research Guide Your Organization's Philanthropy, Cost: \$45 *BH 2208*
- Field Services Alliance Meeting, Cost: Free *BH 2207*

8:30 am–1 pm

- Leadership Forum, Cost: \$115 *BH 2211*

### AFTERNOON WORKSHOP

1:30–5:30 pm

- Demonstrating History's Relevance in Today's World, Cost: \$45 *BH 2208*

### FULL DAY WORKSHOPS

8:30 am–5 pm

- Career Growth Studio, Cost: \$75 *BH 2209*
- To Be More Inclusive: Training and Resources in the Arts and Humanities Field, Cost: \$40 *BH 2210*

### EVENING EVENT

6:30–9:30 pm

- Suburbia Unleashed, Cost: \$45

## THURSDAY SEPTEMBER 27

7 am–6 pm REGISTRATION

### TOURS

6:30–8:30 am

- Run (or Walk) Your Way Into History, Cost: \$35

7–8:30 am

- The Consequences of Time and the Truth of Creative Building Reuse: A Walking Tour of the Crossroads Arts District, Cost: \$20

1:30–4:30 pm

- From Slavery to Freedom: Emancipation and Escape in Antebellum Homes, Cost: \$38

1:30–5:30 pm

- American Creative: Thomas Hart Benton, Cost: \$38

### BREAKFAST

7–8:15 am

- Historic House Breakfast, Cost: \$35 *CC 2502B*

### KEYNOTE

8:30–9:45 am

- Kick-Off Keynote: Dan Snow *CC 3501 A-D*

9:45–10:45 am

- Break in the Exhibit Hall *CC 3501 E-H*
- New Member Reception, Cost: Free *CC 2502B*

### CASE STUDY SESSIONS

10–10:35 pm

- Realistic Collections Moves *BH 2201*
- Thinking about How We Think: Field Trips That Promote Museum Literacy *CC 2502A*

### CONCURRENT SESSIONS

10:45 am–12 pm

- America's Courts: A Place of Truth and Consequences *BH 2202*
- Crowdsourcing Slavery Interpretation Challenges *CC 2505A*
- Detroit67: Looking Back to Move Forward—Truth Leads to Transformation *CC 2504A*
- From the Ground Up: Creating and Building a Culture of Evaluation *BH 2208*
- New Eyes on Old Stories: Challenging Traditional Narratives to Uncover Deeper Truths *CC 2505B*
- On the Road: Doing Midwestern LGBTQ History in Traveling Exhibitions *BH 2207*
- Whiskey for My Staff and Beer for My Llamas: Corporate Partnerships *BH 2203*
- Will Deaccessioning Really Save Your Museum? *BH 2214*

### AFFINITY GROUP LUNCHEONS

12:15–1:30 pm

- Educators and Interpreters, Cost: \$40 *CC 2502A*
- Religious History, Cost: \$40 *BH 2211*
- Small Museums, Cost: \$40 *CC 2502B*
- Women's History, Cost: \$40 *BH 2210*

### CONCURRENT SESSIONS

1:45–3 pm

- Broadcast Yourself *BH 2208*
- Consequences Be Damned! Slavery Remembered and the Risk of Acknowledging Hard Truths *CC 2504A*
- Earned Revenue: Core to Your Institution's Business and Mission *BH 2202*
- Field Services Alliance Tips: Scaling Best Practices to Fit Your Organization *BH 2207*
- Latino Heritage Conservation *BH 2203*
- Reducing Bias in Hiring to Increase Inclusivity *CC 2505A*

- What Is Their Truth? What Do People in Kansas City Really Think about History? *BH 2209*
- Winning the Vote: How to Prepare Your Site for a Celebration 100 Years in the Making *CC 2505B*
- Written and Erased: A Great American Writer, Her Partner, and a Small Nebraska Town *BH 2214*

1:45–3:45 pm

- Legal History Roundtable at the Whittaker U.S. Courthouse *Meet at AASLH Registration Desk*

3–4 pm Break in the Exhibit Hall *CC 3501 E-H*

### CASE STUDY SESSIONS

3:15–3:55 pm

- Beyond the Mansion: Interpreting Diverse Stories Across a Historic Property *CC 2502A*
- You Want To Get What Done When? Digitizing the Phog Allen Papers *BH 2201*

### CONCURRENT SESSIONS

4–5:15 pm

- Advocating for Collections Care Both Internally and Externally *BH 2202*
- All Are Welcome: Staff Training for Inclusion and Ability Awareness at Museums *CC 2505A*
- Confronting Uncomfortable Truths: The American Legacy of Repression and Resistance *CC 2504A*
- From Assumptions to Intolerance: Addressing Visitors' Misconceptions about Religion *CC 2505B*
- Getting Sexy at Historic Sites *BH 2207*
- Reimagining the Historic House Museum *BH 2203*
- Stories and the Absence of Artifacts: A 360 Degree View of Challenges and Solutions in Creating #1 in Civil Rights: The African American Freedom Struggle in St. Louis *BH 2208*
- Truth and Consequences in Developing Programs of Diversity and Inclusion *BH 2209*
- The Wages of History: Emotional Labor on Public History's Front Lines *BH 2214*

### RECEPTIONS

5:30–6:30 pm

- History Leadership Institute, Cost: Free *Marriott Muehlebach Barney Allis Historic Lobby*
- History Happy Hour, Cost: Free

5:30–7 pm

- Diversity and Inclusion Task Force Mixer, Cost: Free *Marriott 12th Street Room – Lobby Level*

### EVENING EVENT

6:30–9:30 pm

- Sunset at the National World War I Museum and Memorial, Cost: \$49

# FRIDAY SEPTEMBER 28

7 am–5 pm REGISTRATION

## BREAKFAST

7–8:15 am

- Military History Breakfast, Cost: \$35 *BH 2203*

8:30–9:45 am

- StEPs Friday Morning MeetUP, Cost: \$10 *BH 2211*

## TOURS

8:30 am–12:30 pm

- The Story of Segregation in Kansas City, Cost: \$38

## CONCURRENT SESSIONS

8:30–9:45 am

- Civil Rights Beyond the South: The Significance of Missouri in the Black Freedom Struggles of the 1960s *BH 2209*
- Communicating Across Divides *Room: CC 2505B*

- Discovering Truth and Unconscious Bias: A Continued Conversation *CC 2505A*

- Pop Up Session *BH 2210*

- Ready for Retirement? *BH 2207*

- Telling the Truth about Woman Suffrage: A Roundtable Discussion *CC 2502B*

- To Tell the Truth: Teaching Difficult History Through an Exhibit *BH 2214*

- Trends and Lessons from the 2018 Leadership in History Awards *CC 2504A*

- The Truth about Millennials as Change-Makers in the Workplace *CC 2504B*

9:45–10:45 pm

- Break in the Exhibit Hall *CC 3501 E-H*
- NCPH Poster Session *CC 3501 E-H*

## CASE STUDY SESSIONS

10–10:30 am

- More Than Speaking Slowly: Transforming Museum Educational Programs for Bilingual Learners *CC 2502A*

- Rebels to Roses: Creating a Volunteer Management Program *BH 2208*

10:45–11:45 am

- AASLH Meeting of the Membership *CC 3501 A-D*

11:45 am–12:30 pm

- Annual Meeting Attendees Luncheon, Cost: \$10 *CC 3501 E-H*



Charlie Parker Memorial

## CONCURRENT SESSIONS

12:30–1:45 pm

- Beyond "Slave" and "Mistress": Improving Women's Interpretation at Historic Sites and Museums *BH 2211*

- Crumbling Pedestals and Monumental Follies: Truth and/or Consequences After Charlottesville *CC 2505A*

- Exploring Ken Burns's Vietnam War: National and Local Perspectives *BH 2207*

- Inspiring Discomfort with Change: The New Alaska Exhibition at the Anchorage Museum *BH 2214*

- Interpreting Controversial Histories through Community Collaboration *CC 2505B*

- *Nomenclature* Reinvented! Making Access to Historical Evidence Easier *CC 2504A*

- The Road to Success: Exploring the Intersection Between Planning and Innovation *BH 2209*

- The Truth about Troost: The Consequences of Engaging Diverse Students in Conversations about Race Based on Local History *BH 2210*

## KEYNOTE

2–3:15 pm

- Keynote Speaker: Cheryl Brown Henderson *CC 3501 A-D*

3:15–4 pm

- Break in the Exhibit Hall *CC 3501 E-H*

## CASE STUDY SESSIONS

3:25–4 pm

- Extending Avenues of Digital Engagement: Crowdsourcing and the Colored Conventions Project *CC 2502A*

- Innovation and Collaboration: The Secret to Organizational Sustainability and Growth *BH 2208*

## CONCURRENT SESSIONS

4–5:15 pm

- 2040: A Museum Odyssey *BH 2211*

- Adapting Existing Programs to Serve Language Learners *BH 2207*

- Change Is Hard, Does It Have to Be? *BH 2214*

- Hire for Culture Or: How I Stopped Worrying and Learned to Love Improv *CC 2504A*

- NAGPRA: The Truth about Repatriation and the Consequences of Returning Collections *BH 2209*

- Racism: Is Your Museum Ready to Talk about It? *CC 2505A*

- Tech or No Tech? That Is the Question When Engaging the Next Generation in History *CC 2505B*

- Truth or Consequences Lightning Talks *BH 2210*

## RECEPTION

5:30–6:30 pm

- Thank You Reception, Cost: Free, Invitation Only *Marriott 12th Street Room – Lobby Level*

## EVENING EVENT

6:30–9 pm

- Leadership in History Awards Banquet, Cost: \$75 *Room: CC 3501 A-D*

# SATURDAY SEPTEMBER 29

8 am–12 pm REGISTRATION

## TOURS

7:30 am–12 pm

- 18th and Vine Historic District, Cost: \$38

8 am–5:30 pm

- A Day in St. Joseph, Cost: \$70

8:30 am–5:30 pm

- Find Your Independence!, Cost: \$70

8:30 am–5:30 pm

- Truth and Consequences: Civil War on the Western Border, Cost: \$70

## CONCURRENT SESSIONS

9–10:15 am

- Betting on History and Culture in Las Vegas *BH 2207*

- Brutal Truths: Making the New Mississippi Civil Rights Museum *CC 2502B*

- Consequences of Truth for Historic Sites *CC 2505A*

- Fulfilling Your Mission When Natural and Manmade Disasters Strike *CC 2502A*

- Innovative Museum Leadership: Challenges and Solutions *BH 2208*

- Interpreting Immigration: Perspectives from Education, Exhibits, and Collections *BH 2214*

- Pop Up Session *BH 2210*

- U.S. 250th Anniversary Information and Listening Session *BH 2209*

10:15–10:30 am Break in Foyer

10:30 am–12 pm

- 2019 Annual Meeting Roundtable *BH 2210*

- A Tale of Two Cities: Building Museums That Are Community Centers, Not Monuments to the Past *BH 2214*

- The Expanding Role of Museums in Adult Citizenship Education *BH 2208*

- Food in the Gallery? *BH 2207*

- The Inclusive Historian's Handbook: A Conversation with the Editors *CC 2505A*

- Locating and Interpreting the Missouri Trail of Tears *BH 2209*

- The Power of Puzzles *CC 2502A*

## LABS

1–5:30 pm

- Digital Show and Tell: Innovative (and Low-Cost) Tools for Engaging New Audiences, Cost: \$35 *BH 2211*

- Inside the White House: The Decision Experience, Cost: \$35 *Harry S. Truman Presidential Library*

- Interpreting World War I: Engaging Audiences in "Overlooked" Histories, Cost: \$35 *National World War I Museum and Memorial*

# Your history, beautifully (and truthfully) told.



"In one way or another I've worked with the people at Orange Frazer Press since 1988. The editorial, design, and business talents of the OFP staff are extraordinary, and the resulting books are visually striking. But as great as these factors are, their quality is in their notion that authors and researchers are not just any clients, but rather people they embrace with kindness and patience."

—**KEVIN GRACE**, *Head of the Archives & Rare Books Library, the University Archivist, and a Senior Librarian, University of Cincinnati*



Spring Grove Cemetery

## Get a quote

[orangefrazer.com/pricing](http://orangefrazer.com/pricing)



Museum of Natural History NYC



The Ohio Statehouse



Public Library of Cincinnati

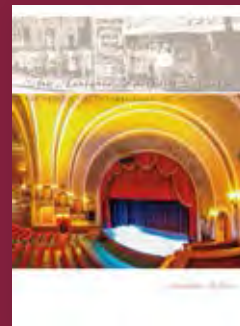

Historic Murphy Theatre



Westcott House Museum

Writing • Editing • Design • Printing • Distribution

ORANGE FRAZER BOOK PUBLISHING  
since 1987

937.382.3196  
[orangefrazer.com](http://orangefrazer.com)



# NATIONAL COUNCIL ON PUBLIC HISTORY *POSTER SESSION*



Be sure to stop by the Exhibit Hall on Friday morning to hear from students and colleagues from around the country as they share their projects.

<b>Building the ALSAC/St. Jude Archive: Transformation and Collaboration</b>	Maxwell Farley	ALSAC/St. Jude, Middle Tennessee State University
<b>Curating Metadata for a Community-Based Archive</b>	Annie Shirley	University of West Georgia
<b>Engaging with Empathy: Staff Support for Emotionally-Charged Museum Exhibitions</b>	Lacey Lieberthal	John F. Kennedy University
<b>Envisioning New Jersey: Using Truthful Images from the Past to Help Understand the Present</b>	Maxine Lurie	Seton Hall University
<b>Find Your Independence</b>	Kristina Eckfeld	City of Independence, Missouri
<b>Historic Decisions: Interpretation through Deliberation</b>	Kathleen Pate and Diane Euston	Arkansas Historic Decisions Learning Exchange
<b>Historical Interpretation Alongside Arts and Culture</b>	Callie Hopkins	American University
<b>Impressions from a Lost World</b>	Sarah Doyle	Pocumtuck Valley Memorial Association
<b>It's Not What We Say But What Visitors Do—Place Matters! A Study of Informal Interpretation in National Parks</b>	Brian Forist, Allison Mincher, Leah Palmer, and Lindsay Burks	Indiana University
<b>Local History and Digital Humanities in Secondary Education</b>	Tim Reidy	Rockhurst High School
<b>Making Collections Accessible for Researchers</b>	Lynn Ward	Spencer Research Library, University of Kansas
<b>Raising America Racist: How Klanswomen Used Education to Implement Systemic Racism</b>	Kate Schoen	University of South Carolina, Public History Program
<b>Re-purposing a Project: The Indiana History Train</b>	Marianne Sheline	Indiana Historical Society
<b>Sorting Out Race: Examining Racial Identity and Stereotypes in Thrift Store Donations</b>	Rachel Pannabecker and Jill Weiss Simins	Kauffman Museum at Bethel College
<b>Talking Hoosier History: An Indiana History Podcast</b>	Lindsey Beckley and Lindsay Strehl	Indiana Historical Bureau
<b>Tell the Truth: Designing the Mississippi Civil Rights Museum</b>	Jill Malusky and Richard Veit	Hilferty
<b>Three Wylie Women: An Exhibit on Late Nineteenth-Century Mothering</b>	Mary Figueroa	Indiana University Bloomington
<b>U.S. Army Heritage and Education Center Veterans Ambassador Program</b>	Sarah Pendleton	U.S. Army Heritage and Education Center
<b>VR: The Reality of Interpreting Difficult History Through Technology</b>	Kyle Mathers, Abigail Seaver, Ally Laubscher, and Kristin Herlihy	First Division Museum
<b>“Whose Digital History:” Closing the Gaps Between Academic Historians, Public Historians, and the Public</b>	Megan Smeznik	The College of Wooster

# FLOOR PLANS

## MARRIOTT DOWNTOWN

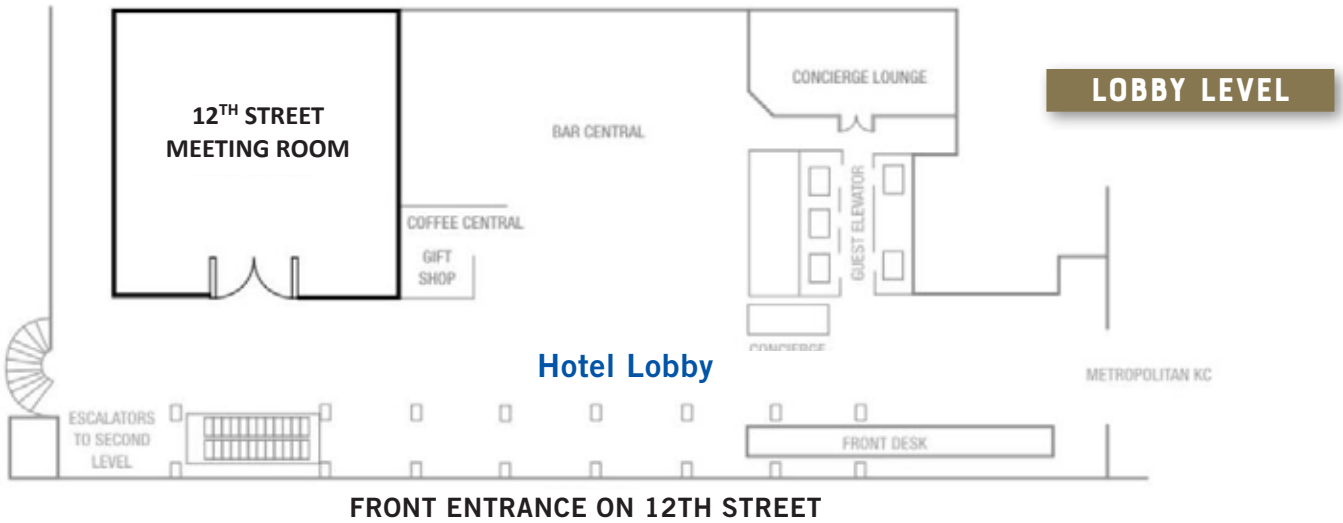

## MUEHLEBACH TOWER

### LOWER LEVEL

HISTORY LEADERSHIP INSTITUTE RECEPTION  
 WILL BE HELD  
 AT MUEHLEBACH TOWER  
 IN THE BARNEY ALLIS HISTORIC LOBBY  
*Enter on 12th Street*

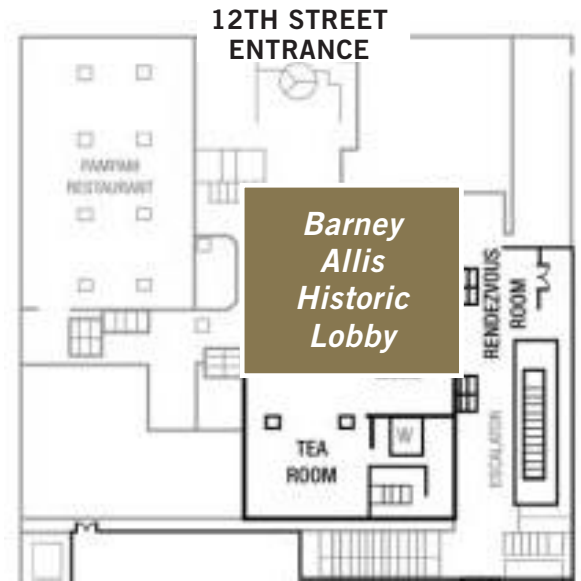

## MARRIOTT DOWNTOWN

### THIRD FLOOR

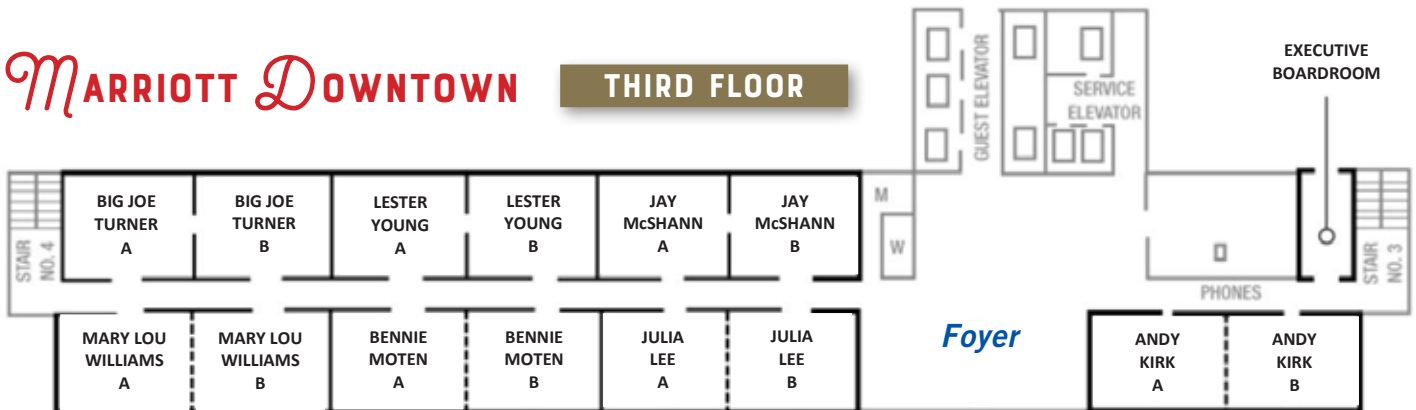



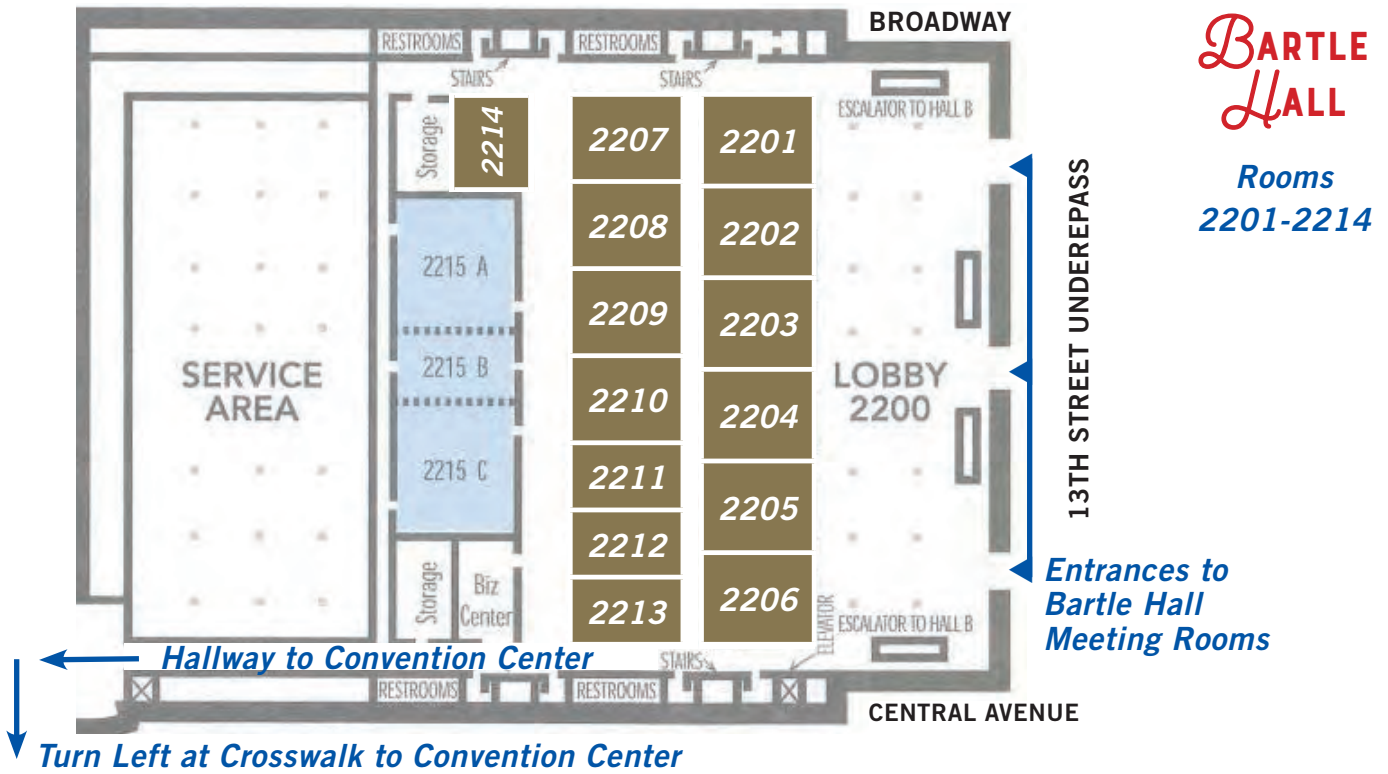

BARTLE HALL IS CONNECTED TO THE CONVENTION CENTER

## CONVENTION CENTER

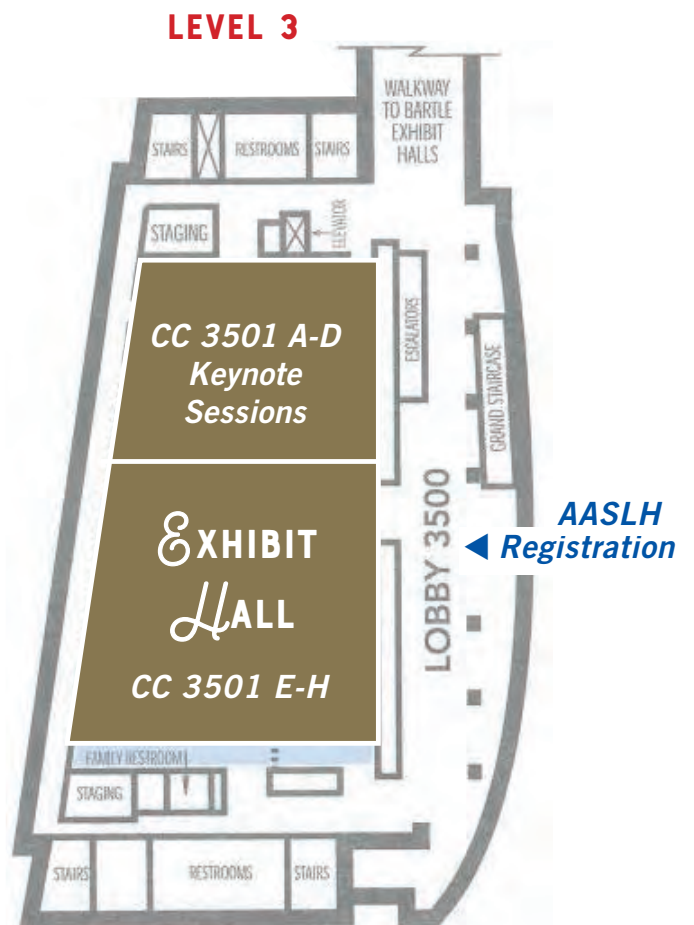
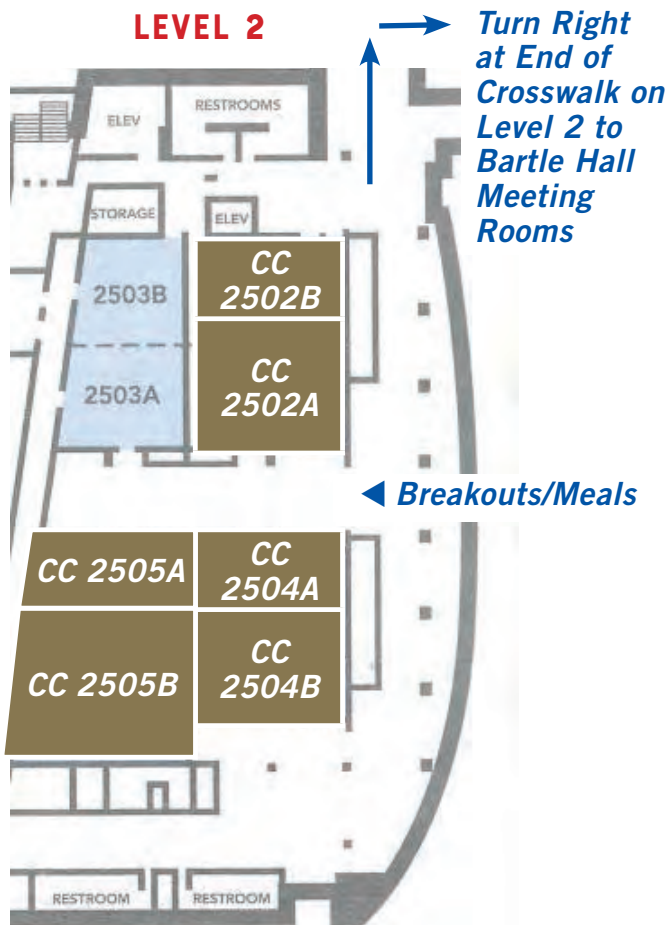

# EXHIBIT HALL HIGHLIGHTS

## EXPLORE NEW PRODUCTS AND SERVICES IN THE EXHIBIT HALL

On Thursday and Friday, don't miss your chance to meet more than fifty vendors and suppliers. The Exhibit Hall is your place to network and check out the latest technology and services being offered, and WIN lots of great prizes.

### THURSDAY, SEPTEMBER 27

9 am	Exhibit Hall Opens
9:45–10:45 am	Morning Refreshment Break
3–4 pm	Afternoon Refreshment Break
5:15 pm	Exhibit Hall Closes

### FRIDAY, SEPTEMBER 28

9 am	Exhibit Hall Opens
9:45–10:45 am	Morning Refreshment Break and NCPH Poster Session
3:15–4 pm	Afternoon Refreshment Break
4 pm	Exhibit Hall Closes



## AASLH CONVERSATIONS

Drop by the AASLH Conversations Area, located at Lobby 3500, to discuss current topics, discover helpful resources, and make new connections. Everyone is invited! A full description of Conversations is available on the AASLH app and at the registration desk.

### THURSDAY, SEPTEMBER 27

10–10:45 am	Small Museums 20,000 Strong
11–11:45 am	Tracking Public History Career Paths
2–2:45 pm	Hidden History: Balancing Corporate Needs and History
3–3:45 pm	In a Rut? Jumpstart Positive Change!
4–4:45 pm	What's Next in Your Small Museum Career?

### FRIDAY, SEPTEMBER 28

10–10:45 am	Free Legal [History] Advice
11–11:45 am	Collections Conundrums
11:45 am–12:30 pm	Writing for AASLH
12:45 am–1:45 pm	Choosing Collections Management Software
3:15–4 pm	Visitors Count! Q & A

# EXHIBITORS

Company .....	Booth Number
106 Group .....	314
53Tom LLC .....	106
AASLH .....	403
ALHFAM .....	311
American Alliance of Museums .....	305
BearWallowBooks Publishing .....	307
BW&A Books—Book Design and Production .....	212
Collector Systems, LLC .....	201
Conservation Center for Art & Historic Artifacts .....	303
Cowan's Auctions .....	306
Crystalizations Systems Inc .....	107
Delta Designs Ltd. ....	110
The Donning Company Publishers .....	200
Dorfman Museum Figures, Inc. ....	214
Eisenhower Foundation .....	215
Emporia State University, School of Library and Information Management .....	405
Flying Fish Exhibits .....	400
The Foundation of the American Institute for Conservation of Historic and Artistic Works .....	301
Freedom's Frontier National Heritage Area .....	109
Gaylord Archival .....	114
Hartsook .....	115
The Heritage League of Greater Kansas City .....	202
HistoryIT .....	104
Hollinger Metal Edge .....	300
Institute of Museum and Library Services .....	213
Lamcraft Inc. ....	315
Lark Label .....	406

Company .....	Booth Number
Lucidea .....	101
LYRASIS .....	302
MBA Design & Display Products Corp. ....	310, 312
McCullogh Creative .....	412
The MediaPreserve .....	210
Mid-America Arts Alliance/NEH on the Road/ExhibitsUSA. ....	108
Mid-Continent Public Library .....	105
Missouri Humanities Council .....	404
Missouri State Archives .....	408
National Archives Traveling Exhibits Service .....	308
National Council on Public History .....	209
National Endowment for the Humanities .....	410
National World War I Museum and Memorial .....	206
NEDCC—Northeast Document Conservation Center .....	113
Northern Micrographics .....	204
OnCell .....	414
Organization of American Historians .....	208
PastPerfect Software .....	309
Re:discovery Software, Inc. ....	111
Ride Into History .....	100
Rowman & Littlefield .....	205, 207
Split Rock Studios .....	103
Tools From the Earth .....	116
Tour-Mate Systems .....	203
University of Oklahoma Extended Campus .....	304
U.S. Army Heritage and Education Center .....	313
U.S. Citizenship and Immigration Services .....	211
Wide Awake Films .....	402

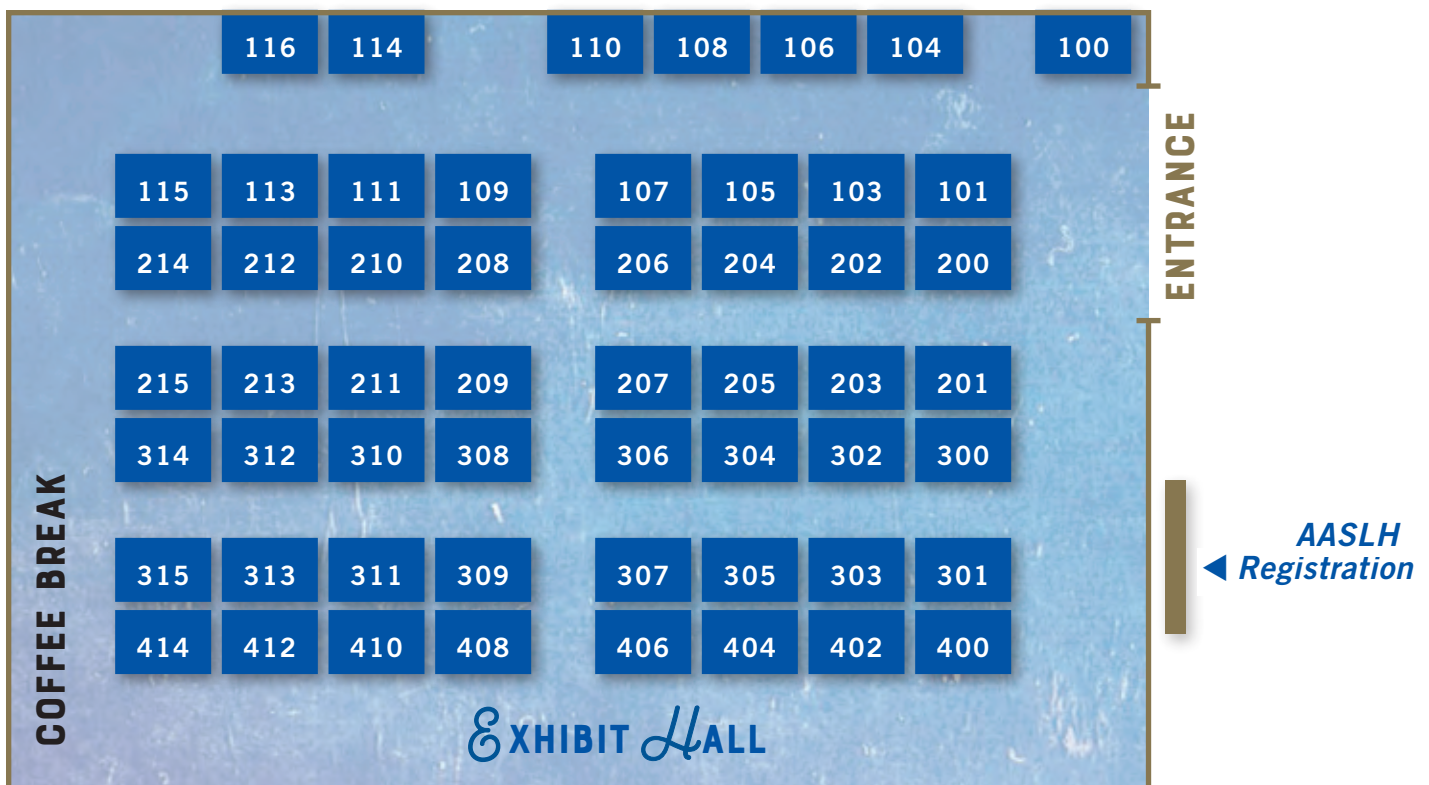

## 106 Group

### Booth #314

**Contact:** Regine Kennedy  
1295 Bandana Blvd., Ste. 335  
St Paul, MN 55108  
**Phone:** 651-290-0977  
**Email:** reginekenedy@106group.com  
**Web:** www.106group.com

The 106 Group is a project-based company providing services related to:

- Regulatory and process primarily for Section 106, NEPA, and other regulatory processes
- Planning and engagement primarily for local and underrepresented cultural communities
- Archaeology and history primarily for regulatory and broader planning projects
- Interpretation and design primarily for creative media, presentations, and exhibits

## 53Tom LLC

### Booth #106

**Contact:** Tom Styrkowitz  
**Phone:** 913-940-8900  
**Email:** photo@53tom.com  
**Web:** www.53tom.com

ONEbyONE Community Portraits... a community building event where I create as many as 1246 portraits of your guests in a three day period.

## American Association for State and Local History

### Booth #403

**Contact:** Darah Fogarty  
**Phone:** 615-320-3203  
**Email:** fogarty@aaalh.org  
**Web:** www.aaalh.org

AASLH is the professional association for history-doers. Whether you are the director of a history museum, a volunteer at a historical society, a genealogist, an educator at a historic house, a history teacher, an avocational historian, an archivist, or in one of the many other important roles in the history field, AASLH is your community.

## Association for Living History, Farm, and Agricultural Museums

### Booth #311

**Contact:** Deborah Arenz  
P.O. Box 16  
Rochdale, MA 01542  
**Phone:** 402-904-6938  
**Email:** president@alhfam.org  
**Web:** www.alhfam.org

An international museum association serving museums and practitioners of living history and historic agriculture.

## American Alliance of Museums

### Booth #305

**Contact:** Janet Vaughan  
2451 Crystal Dr.  
Arlington, VA 22202  
**Phone:** 202-289-9120

**Email:** jvaughan@aam-us.org

**Web:** www.aam-us.org

The Alliance nurtures excellence in your museum and offers a number of tools you can use in making the case for your museum and the field.

## BearWallowBooks Publishing

### Booth #307

**Contact:** Linda Wolfe  
7172 N. Keystone Ave., Ste. A  
Indianapolis, IN 46240  
**Phone:** 800-232-7925

**Email:** sales@bearwallowbooks.com

**Web:** www.bearwallowbooks.com  
Old-fashioned recipe books and American history. Great price point, great value. Printed in U.S.A. Many titles to choose from to fit your time period and location.

## BW&A Books—Book Design and Production

### Booth #212

**Contact:** Chris Crochetiere  
112 W. McClanahan St.  
Oxford, NC 27565  
**Phone:** 919-956-9111

**Email:** chris@bwabooks.com

**Web:** www.bwabooks.com  
Providing book design and production services since 1988.

## Collector Systems, LLC

### Booth #201

**Contact:** Eric Kahan  
169 Hudson St.  
New York, NY 10013  
**Phone:** 212-431-0897

**Email:** info@collectorsystems.com

**Web:** www.collectorsystems.com  
Collector Systems is the ideal cloud-based solution for museum collections management. Since 2003, we have provided top institutions access to their information from any computer, tablet, or phone with an internet connection. A Spectrum Partner, CS facilitates all museum operations (small and large)—from accessions to online exhibitions. Our import tool allows existing collections data (including images and documents) to be uploaded to our secure cloud—where it can be securely searched, sorted, and shared from any web browser. Chenhall's *Nomenclature 4.0*, Getty ULAN, and AAT are integrated to help standardize collections, and our built-in Gallery feature allows institutions to share collections as a public website (and a comprehensive API is available for even more fine-grained access to collections data). Visit Booth 201 to see how institutions including Stearns History Museum, South Street Seaport Museum, Masterworks of Bermuda Art, and the Museum of Democracy use Collector Systems.

## Conservation Center for Art & Historic Artifacts

### Booth #303

**Contact:** Samantha Forsko  
264 South 23rd St.  
Philadelphia, PA 19103  
**Phone:** 215-545-0613

**Email:** aheuer@ccaha.org

**Web:** www.ccaha.org

We help organizations care for their collections. Based in Philadelphia, we've worked with institutions nationwide for over 40 years. Through collections care training, preservation assessments and planning, grantwriting assistance, and conservation treatment of paper-based materials, we work toward preserving the world's cultural heritage.

## Cowan's Auctions

### Booth #306

**Contact:** Jutta Lafley  
6270 Este Ave.  
Cincinnati, OH 45232  
**Phone:** 513-871-1670

**Email:** Jutta.lafley@cowans.com

**Web:** www.cowanauctions.com

With offices in Cincinnati, Cleveland, and Denver, Cowan's holds over 40 auctions each year, with annual sales exceeding \$16M. A full-service house, Cowan's Auctions is also a leader in the industry, having disrupted the marketplace from the start. We were among the earliest auction houses to launch a website and one of the first to sell online. In 2014, Cowan's, along with five of our competitors, launched bidsquare.com, an online bidding platform where auction houses are vetted to ensure honesty and quality.

## Crystalizations Systems Inc

### Booth #107

**Contact:** Patricia Ellenwood  
1401 Lincoln Ave.  
Holbrook, NY 11741-2215  
**Phone:** 631-467-0090

**Email:** info@csistorage.com

**Web:** www.csistorage.com

We design, manufacture, and install safe lightweight aerospace Aluminum Collection Storage Systems that require no maintenance. Our industry-leading Moving Painting and Rolled Textile Storage Systems are available in any size. Floor, Ceiling, and Free-Standing supported installations. Aisles are always TrackFree.

## Delta Designs Ltd.

### Booth #110

**Contact:** Peter Doucette  
1535 NW 25th St.  
Topeka, KS, 66618

**Phone:** 785-234-2244 x220

**Email:** pdoucette@deltadesignsltd.com

**Web:** www.deltadesignsltd.com

Delta Designs Ltd. specializes in the design and professional manufacture of high-quality

museum storage equipment. We now offer the full complement of collection storage including cabinets, flat files, mobile systems, art racks, and open shelving. Our products meet the highest standards of conservation practices. Delta Designs Ltd. the most trusted name for collection storage.

## The Donning Company Publishers

### Booth #200

**Contact:** Nate Salgado, Geoffrey Bass

731 S. Brunswick St.  
Brookfield, MO 64628

**Phone:** 800-369-2646 x3377

**Email:** nathan.stuffbean@donning.com

**Web:** www.donning.com

The Donning Company Publishers specializes in commemorative pictorial histories and contemporary portraits. Donning's books are custom-tailored to celebrate and preserve the heritage of organizations, such as, but not limited to: associations, churches, clubs, cooperatives, corporations, educational institutions, hospitals, military and multicultural groups, resorts, and state/local. We offer full production services.

## Dorfman Museum Figures, Inc.

### Booth #214

**Contact:** Joe Bezold  
6224 Holabird Ave.

Baltimore, MD 21224

**Phone:** 800-634-4873

**Email:** joe@museumfigures.com

**Web:** www.museumfigures.com

Dorfman Museum Figures, Inc. has been serving the museum community for over fifty years. Originally specializing in creating life-size, lifelike figures for museums, DMF has sculpted the likenesses of 800 people and created over 5,000 realistic figures for museums, visitor centers, design/exhibit companies, and private clients. DMF also fabricates a comprehensive line of conservational sound forms out of Ethafoam™ for storage and display of high value artifact clothing.

## Eisenhower Foundation

### Booth #215

**Contact:** Mitzi Bankes Gose  
PO Box 295

Abilene, KS 67410

**Phone:** 785-263-6793

**Email:** mbgose@eisenhowerfoundation.net

**Web:** www.eisenhowerfoundation.net

IKEducation provides K-12 educational experiences that promote the life and times of Dwight D. Eisenhower at his Presidential Library, Museum, and Boyhood Home.

## Emporia State University, School of Library and Information Management

Booth #405

**Contact:** Emily Sanders-Jones,  
1 Kellogg Circle, Emporia, KS  
66801

**Phone:** 620-341-5203

**Email:** esanders2@emporia.edu

**Web:** www.emporia.edu/slim  
The Emporia State University  
School of Library and Information  
Management is the oldest in the  
western half of the United States.  
It is currently the only program  
in Kansas accredited by the  
ALA. The School of Library and  
Information Science currently  
offers courses at six program sites  
in Colorado, Kansas, Oregon,  
Utah, and South Dakota.

## Flying Fish Exhibits

Booth #400

**Contact:** Carrie Reid

**Phone:** 320-309-4001

**Email:** carrier@fishingfishexhibits.com

**Web:** www.flyingfishexhibits.com  
Flying Fish provides a compre-  
hensive consulting, sales &  
marketing, and operational  
management service to the  
touring exhibition industry  
around the world. Working  
exclusively with museums and  
science centers, Flying Fish is a

trustworthy and reliable choice  
for consulting, sales & marketing,  
and operational management.

## The Foundation of the American Institute for Conservation of Historic and Artistic Works

Booth #301

**Contact:** Elizabeth Handwerk Kurt  
727 15th St. NW, Ste. 500  
Washington DC, 20005

**Phone:** 202-750-3437

**Email:** ekurt@conservation-us.org

**Web:** www.conservation-us.org  
Information about the Foundations  
Programs including Collections  
Assessment for Preservation  
Program (CAP), Emergency  
Programs, and Connecting to  
Collections Care (C2CC).

## Freedom's Frontier National Heritage Area

Booth #109

**Contact:** Jim Ogle

200 West 9th St.

Lawrence, KS 66044

**Phone:** 785-856-3635

**Email:** jogle@freedomfrontier.org

**Web:** www.freedomfrontier.org  
Freedom's Frontier NHA brings  
together sites and museums  
around the Missouri-Kansas  
border that tell the stories of the  
settlement of the frontier, the  
Border and Civil Wars, and the

enduring struggle for freedom that  
makes this area unique and inter-  
esting to visit.

## Gaylord Archival

Booth #114

**Contact:** Maryellen Dodge

PO Box 4901

Syracuse, NY 13221-4901

**Phone:** 800-448-6160

**Email:** ashlyn.mccarty@gaylord.com

**Web:** www.gaylord.com

Choose Gaylord Archival for all  
your exhibit, display and storage  
needs. From handcrafted boxes  
to museum-quality cabinets to  
our fully demountable Frank  
Showcase system—we have it all.

## Hartsook

Booth #115

**Contact:** Tammy Weinman

PO Box 410046

Kansas City, MO 64141

**Phone:** 866-630-8500 x8225

**Email:** tammy@hartsookcompa-  
nies.com

**Web:** www.hartsookcompanies.com

Hartsook has a decades-long tradi-  
tion of growing philanthropy for  
nonprofits. We have unique strate-  
gies that ensure successful regular  
giving while building support for  
capital, program, and endowment.  
Nonprofits may retain Hartsook  
for everything from general

fundraising guidance to handling  
the day-to-day tasks of a campaign  
or development operation.

## The Heritage League of Greater Kansas City

Booth #202

**Contact:** Andrew R. Gustafson

8788 Metcalf Ave.

Overland Park, KS 66212

**Phone:** 913-715-2551

**Email:** andrew.gustafson@jocogov.org

**Web:** www.heritageleaguekc.org

The Heritage League is a  
nonprofit, membership organi-  
zation representing museums  
and agencies dedicated to the  
preservation of cultural heritage.  
Membership includes over 100  
museums, archives, historical  
societies, historic sites, and  
individuals in an eight-county  
region surrounding Greater  
Kansas City. The Heritage  
League's "History Map" (print-  
ed and digital) is an important  
resource for residents and tourists  
alike, who wish to connect with  
the local history/heritage commu-  
nity. The Heritage League also  
sponsors workshops to improve  
professional practices in area  
agencies, public events to height-  
en community awareness of  
historical agencies and issues  
affecting them, and social events

# WHERE WE HONOR COURAGE HAS A HISTORY.



## SOLDIERS MEMORIAL

Opens November 3! [mohistory.org/memorial/stay-connected/](http://mohistory.org/memorial/stay-connected/)



MISSOURI HISTORICAL SOCIETY



MISSOURI  
HISTORY  
MUSEUM



LIBRARY &  
RESEARCH  
CENTER



SOLDIERS  
MEMORIAL

FIND YOURSELF HERE.

to provide networking opportunities among those working in area organizations.

## HistoryIT

### Booth #104

**Contact:** Donny Lowe  
245 Commercial St.  
Portland, ME 04101  
**Phone:** 207-699-4222  
**Email:** dl@historyit.com  
**Web:** www.historyit.com  
HistoryIT provides software and services that provide clients with a new approach to making historical collections more useful, meaningful, and accessible. We bring industry-leading expertise to preserve historical collections of all types and sizes and to make them searchable in meaningful ways. Working with cultural institutions, universities, corporations, professional associations, sports teams, and others, HistoryIT leverages cutting-edge technologies, proprietary methodologies, and the subject matter expertise and commitment of our team to create appealing, effective digital portals for historical resources.

## Hollinger Metal Edge

### Booth #300

**Contact:** Abby Shaw  
9401 Northeast Dr.  
Fredericksburg, VA 19147  
**Phone:** 215-990-5306  
**Email:** abbyashaw@me.com  
**Web:** www.hollingermetalede.com  
With over 75 years of experience in a full range of archival materials, Hollinger Metal Edge provides the highest quality archival supplies to museums, historical societies, libraries, historic houses and other small and large collections. Whether a catalog item or a custom product to your design, we offer outstanding customer service and pricing. Please visit our booth to see new products and services.

## Institute of Museum and Library Services

### Booth #213

**Contact:** Daniel Leunig  
955 L'Enfant Plaza North  
Southwest #4000  
Washington, DC 20024  
**Phone:** 202-653-4702  
**Email:** dleunig@imls.gov  
**Web:** www.imls.gov  
The Institute of Museum and Library Services is the primary source of federal support for the nation's libraries and museums. We advance, support, and empower America's museums, libraries, and related organizations through grantmaking, research, and policy development. Our vision is a nation where museums and libraries work together to transform the lives of individuals and communities.

## Lamcraft Inc.

### Booth #315

**Contact:** Rick Gentry  
4131 NE Port Dr.  
Lee's Summit, MO 64064  
**Phone:** 816-795-5505  
**Email:** rgentry@lamcraft.com  
**Web:** www.museumbookmarkcollection.com  
Lamcraft customers receive professional custom designs with no additional set up fees, running charges, or hidden fees. Our designers do not merely insert your images into pre-designed templates; all photographs submitted for use are individually evaluated and a design is then created showcasing your images to best advantage. Every design is a unique one-of-a-kind creation.

## Lark Label

### Booth #406

**Contact:** Karl Miller  
**Phone:** 316-682-5275  
**Email:** karl@larklabel.com  
**Web:** www.larklabel.com  
Designing beautiful garden landscapes and growing great looking plants is by itself an elaborate job and worrying about plant signs shouldn't be one of your problems. Lark Label designs are great-looking, easy-to-read, and long-lasting.

## Lucidea

### Booth #101

**Contact:** Christine Reynolds  
13560 Maycrest Way, Ste. 1115  
Richmond, British Columbia,  
Canada V6V 2W9  
**Phone:** 604-278-6717  
**Email:** creynolds@lucidea.com  
**Web:** www.lucidea.com  
Lucidea Argus is a comprehensive, highly configurable collections management system that accommodates diverse curatorial and visitor engagement requirements for museums of all sizes and budgets. With this integrated platform, you can offer a Web portal and mobile capabilities for expanded access and an enriched visitor experience. Argus: collections management for forward-thinking museums.

## LYRASIS

### Booth #302

**Contact:** Kenna Juliani  
1438 West Peachtree St. NW,  
Ste. 150  
Atlanta, GA 30309  
**Phone:** 800-999-8558  
**Email:** kenna.juliani@lyrasis.org  
**Web:** www.lyrasis.org  
LYRASIS is the nation's longest serving nonprofit for libraries, archives, and museums. We are a member-driven organization whose mission is to support enduring access to our shared academic, scientific, and cultural heritage through leadership in open technologies, content

services, digital solutions, and collaboration with archives, libraries, museums, and knowledge communities worldwide. We do this through world-class programs, services, and leadership opportunities like the Leaders Circle, the Catalyst Fund, LYRASIS Learning, and more.

## MBA Design & Display Products Corp.

### Booth #310, 312

**Contact:** John Peterson  
35 East Uwchlan Ave., Ste. 310  
Exton, PA 19341  
**Phone:** 800-635-7386  
**Email:** info@mba-usa.com  
**Web:** www.mba-usa.com  
MBA Design & Display Products Corp. is the manufacturer of Mila-wall® moveable wall systems, SCENARIO® temporary walls, and over 170 styles and colors of MBA surface coverings. Mila-wall is used in museums and art galleries throughout the world, trade show exhibits, as well as office partitions. Our surface coverings are self-adhesive vinyls that can be applied to walls, cabinets, counters—just about anything.

## McCullough Creative

### Booth #412

**Contact:** Bob Neumann  
10446 Ironwood Dr.  
Tamarack Business Park  
Dubuque, IA 52003  
**Phone:** 563-556-2392  
**Email:** bob@shootforthemoon.com  
**Web:** www.shootforthemoon.com  
McCullough Creative is an extension of your marketing department. With experience and expertise in advertising, displays and exhibits, digital campaigns, publications, video, illustrations, and photography, we know what works. If you're ready for a no-hassle, reliable supplier with creative capabilities in all things marketing, put us in the ring.

## The MediaPreserve

### Booth #210

**Contact:** Robert Strauss  
111 Thomson Park Dr.  
Cranberry Township, PA 16066  
**Phone:** 724-779-2111  
**Email:** strauss@ptlp.com  
**Web:** www.ptlp.com/en/mediapreserve/overview/about-us  
The MediaPreserve uses expertly modified legacy audio, video, and film equipment combined with current technologies to provide reformatting services for preservation and access. We employ a highly trained staff of librarians, archivists, and metadata specialists to create high quality digital files and client-specific metadata.

## Mid-America Arts Alliance/ NEH on the Road/ExhibitsUSA

### Booth #108

**Contact:** Amanda Wiltse  
2018 Baltimore Ave.  
Kansas City, MO 64108  
**Phone:** 816-800-0925  
**Email:** amanda@maaa.org  
**Web:** www.maaa.org  
Mid-America Arts Alliance organizes traveling arts and humanities exhibitions for NEH on the Road (in partnership with the National Endowment for the Humanities) and for ExhibitsUSA.

## Mid-Continent Public Library

### Booth #105

**Contact:** Cheryl Lang  
3440 S. Lee's Summit Rd.  
Independence, MO 64055  
**Phone:** 816-252-7228  
**Email:** clang@mymcpl.org  
mlivengood@mymcpl.org  
**Web:** www.mymcpl.org  
The Midwest Genealogy Center is one of the United States' preeminent resources for family history, providing access to almost three-quarters of a million on-site materials. They provides access to databases, scanning and digitization stations, oral history recording kits, microfilm reader scanners, and more. The Story Center offers unique services that empower library customers to create stories, share those stories, and connect with the stories of others. The Story Center celebrates and develops writers, performers, and filmmakers through access to free resources, workshops, and a community of storytellers.

## Missouri Humanities Council

### Booth #404

**Contact:** Caitlin Yager  
415 South 18th St., Ste. 100  
St. Louis, MO 63103  
**Phone:** 315-781-9960  
**Email:** caitlin@mohumanities.org  
**Web:** www.mohumanities.org  
Missouri Humanities Council provides programming that encourages family reading, highlights Missouri's heritage, supports creative writing by veterans, and assists locals museums, libraries, and other organizations promoting education – facilitating public conversations on topics that include history, religion, archaeology, anthropology, philosophy, literature, law, ethics, and languages.

## Missouri State Archives

### Booth #408

**Contact:** Shelly Croteau  
600 West Main St.  
Jefferson City, MO 65101  
**Phone:** 573-751-4936  
**Email:** shelly.croteau@sos.mo.gov  
**Web:** www.sos.mo.gov/archives  
The Missouri State Archives is the official repository for state records

of permanent and historical value. Its mission is to foster an appreciation of Missouri history and illuminate contemporary public issues by preserving and making available the state's permanent records to its citizens and their government.

## National Archives Traveling Exhibits Service

**Booth #308**

**Contact:** Dee Harris  
400 West Pershing Rd.  
Kansas City, MO 64108  
**Phone:** 816-268-8086  
**Email:** dee.harris@nara.gov  
**Web:** www.archives.gov/exhibits/nates

The National Archives Traveling Exhibits Service (NATES) offers affordable traveling exhibits for museums, libraries, historic sites, and cultural centers that engage and inspire diverse audiences. These exhibits draw from the holdings of the National Archives a national network of federal archives, Presidential libraries, and records centers.

## National Council on Public History

**Booth #209**

**Contact:** Meghan Hillman  
127 CA – IUPUI  
425 University Blvd.

Indianapolis, IN 46202  
**Phone:** 317-274-2716  
**Email:** meghillm@iupui.edu  
**Web:** www.ncph.org  
The National Council on Public History (NCPH) is a membership association dedicated to making the past useful in the present and to encourage collaboration between historians and their publics. Our work begins in the belief that historical understanding is of essential value in society. Our members include museum professionals, historical consultants, historians employed in government, archivists, historical administrators, corporate and business historians, cultural resource managers, curators, oral historians, professors and students with public history interests, and many others.

## National Endowment for the Humanities

**Booth #410**

**Contact:** Patricia Brooks  
**Phone:** 202-606-8297  
**Email:** pbrooks@neh.gov  
**Web:** www.neh.gov  
That National Endowment for the Humanities is an independent federal agency and one of the largest funders of humanities programs in the United States.

NEH grants typically go to cultural institutions, such as museums, archives, libraries, colleges, universities, public television, radio stations, and to individual scholars.

## National World War I Museum and Memorial

**Booth #206**

**Contact:** Mike Vietti  
2 Memorial Dr.  
Kansas City, MO 64108  
**Phone:** 816-888-8100  
**Email:** mike.vietti@theworldwar.org

**Web:** www.theworldwar.org  
The National WWI Museum and Memorial is America's leading institution dedicated to remembering, interpreting, and understanding the Great War and its enduring impact on the global community.

## NEDCC—Northeast Document Conservation Center

**Booth #113**

**Contact:** Julie Martin  
100 Brickstone Sq.  
Andover, MA 01810  
**Phone:** 978-470-1010  
**Email:** jmartin@nedcc.org  
**Web:** www.nedcc.org  
Founded in 1973, the Northeast Document Conservation Center is the first nonprofit conservation

center in the U.S. to specialize in the preservation of paper-based materials for museums, libraries, archives, and other cultural organizations, as well as private collections. NEDCC serves clients nationwide, providing book, paper, and photograph conservation treatment, digital imaging, audio preservation, assessments, consultations, training programs, and disaster assistance. The Center's website is a trusted resource for preservation information in the U.S. and worldwide.

## Northern Micrographics

**Booth #204**

**Contact:** Al Hamilton  
2004 Kramer St.  
La Crosse, WI 54603  
**Phone:** 800-236-0850  
**Email:** alan.hamilton@nmt.com  
**Web:** www.normicro.com  
For over 60 years, Northern Micrographics has partnered with clients in library, academic, commercial, and industrial markets to provide superior preservation imaging products and services. We scan a variety of object types including bound and disbound volumes, photos, maps, microfilm, and microfiche. Northern Micrographics can also help place



# MORE ART FOR MORE PEOPLE

Through ExhibitsUSA and NEH on the Road exhibitions organized and traveled by Mid-America Arts Alliance

ExhibitsUSA



2018 BALTIMORE AVE., KANSAS CITY, MISSOURI 64108 | [WWW.MAAA.ORG](http://WWW.MAAA.ORG) | 816-800-0925

Clockwise from upper left: Jacob A. Rice, "3 Souls"—Little Katie from the Wind Street Industrial School, 1895–1897; 8 x 5 inches, Museum of the City of New York, 90.1.1.133; Don Antonio Ramirez Soled, untitled, 1990–2011; giclée print, 15 1/2 x 11 1/2 inches, Courtesy of David Glasville Collection; Photo: Garcia Requena Contemporary; Tom Fritsch, Fritz Kuhn, seated next to an agave plant, 1977; image courtesy of Library of Congress, Prints and Photographs Division; Dan Prush, John playing solo on the makeshift stage at the prison cafeteria, 1968; digital scan from original negative, 30 x 20 inches, Courtesy of the artist; J. Borges, O Afonso da Serfisa (Alfonso of the Blackland), N.D., woodcut print, 27 x 19 inches, courtesy Cury/Wide – Popular Arts of the Americas, © J. Borges, image: Paul Brinnau; David Halpern, Marving, Bryce Ambs/Breweir, 2004; digital 24bit print, 93 x 40 inches, Courtesy of the artist.

your digital collections online with our software products, ProSeek® and PhotoAtlas™. We also offer a variety of other services including microfilming, microfilm duplication, metadata development, data conversions, hosting, and book binding.

## Organization of American Historians

### Booth #208

**Contact:** Elisabeth Marsh  
112 N. Bryan Ave.  
Bloomington, IN 47408  
**Phone:** 812-855-7311  
**Email:** emarsh@oah.org  
**Web:** www.oah.org  
Founded in 1907, the Organization of American Historians is the largest professional society dedicated to the teaching and study of American history. The mission of the organization is to promote excellence in the scholarship, teaching, and presentation of American history, and to encourage wide discussion of historical questions and the equitable treatment of all practitioners of history.

## PastPerfect Software

### Booth #309

**Contact:** Sara Van De Carr  
300 N. Pottstown Pike, Ste. 200  
Exton, PA 19341  
**Phone:** 800-562-6080  
**Email:** sara@museumsoftware.com  
**Web:** www.museumsoftware.com  
PastPerfect Software is committed to providing professional and affordable software solutions that meet the needs of museums of all sizes. Trusted by over 9,800 organizations around the world, PastPerfect has transformed how museums catalog collections and manage relationships with members and donors.

## Re:discovery Software, Inc.

### Booth #111

**Contact:** Brandy Adams  
3040 Berkmar Dr., Ste. B1  
Charlottesville, VA 22901  
**Phone:** 434-975-3256  
**Email:** brandy@rediscov.com  
**Web:** www.rediscovsoftware.com  
With a Proficio museum and archival collections management system, you will find your daily tasks are simplified, whether its data entry, updating, searching, reporting, or researching. You can also use our Web Module to share the collection online! We are more than just a Collection Management Software company. We are a team of museum and archives professionals and top-notch software engineers. Your system will be supported and upgraded. Seamless conversions and Cloud hosting are available.

## Ride Into History

### Booth #100

**Contact:** Ann Birney, PhD, Joyce Thierer, PhD  
2886 Hwy 99 Rd. R  
Admire, KS 66830  
**Phone:** 620-528-3580  
**Email:** ridehist@satelephone.com  
**Web:** www.historicperformance.com  
Ride into History is the historical performance touring troupe of Joyce Thierer and Ann Birney. In addition to performing their signature first-person narratives of Calamity Jane and Amelia Earhart and other historic and composite figures, they conduct workshops and camps, and wrote the recently-published *Performing History: How to Research, Write, Act, and Coach Historical Performances* (Rowman & Littlefield for AASLH) and *Telling History: A Manual for Performers and Presenters of First Person Narratives*. The scholar/performers both have doctorates and have been on rosters of arts and humanities organizations. Dr. Thierer is a tenured member of the history faculty at Emporia State University. Dr. Birney has completed John F. Kennedy Center for the Performing Arts "Artists as Educators" Seminars.

## Rowman & Littlefield

### Booth #205, #207

**Contact:** Karin Cholak  
4501 Forbes Blvd., Ste. 200  
Lanham, MD 20706  
**Phone:** 203-966-7942  
**Email:** kcholak@rowman.com  
**Web:** www.rowman.com  
Rowman & Littlefield, co-publisher of AASLH books, publishes books by museum professionals for museum professionals. Our books offer the best guidance available on an amazingly wide range of topics, including: planning a new museum; best practices for running museums; for curating a collection; interpreting history; presenting a program; or teaching the next generation of museum professionals.

## Split Rock Studios

### Booth #103

**Contact:** Colin Cook  
2071 Gateway Blvd.  
St. Paul, MN 55112  
**Phone:** 651-631-2211 x728  
**Email:** ccook@splitrockstudios.com  
**Web:** www.splitrockstudios.com  
We specialize in creating cultural and natural history exhibits for museums, interpretive centers, and political institutions. From coast to coast, our team of museum experts brings stories to life. Our client trust and enjoy our design and fabrication process because it is collaborative, creative, and organized. Some of

our clients include the Kentucky History Center, Dole Institute of Politics, National Museum of the Great Lakes, National Purple Heart Hall of Honor in New Windsor, Ford's Theater, the Center for Education and Leadership in Washington, DC, and the Detroit Museums Pop-Up.

## Tools From the Earth

### Booth #116

**Contact:** Terry Powell  
5211 E. Pembroke Circle  
Wichita, KS 67220  
**Phone:** 727-580-1325  
**Email:** toolsfromtheearth@gmail.com  
**Web:** www.toolsfromtheearth.com  
We make prehistoric Native American tools for museum exhibits and educational programs.

## Tour-Mate Systems

### Booth #203

**Contact:** Roya Dostzadah  
137 St. Regis Cres. S.  
Toronto, Ontario M3J 1Y6  
**Phone:** 416-636-5654  
**Email:** rdostzadah@tourmate.com  
**Web:** www.tourmate.com  
Tour-Mate is one of North America's leading providers of audio and multimedia interpretive platforms. From hand held audio and multimedia to mobile applications to eco-friendly outdoor stationary platforms. Tour-Mate is your one stop shop for interpretive hardware and content creation services.

## University of Oklahoma Extended Campus

### Booth #304

**Contact:** Christine Young  
1610 Asp Ave., Ste. 108  
Norman, OK 73072  
**Phone:** 405-325-1061  
**Email:** museumsonline.ou.edu  
**Web:** www.pacs.ou.edu  
OU Extended Campus offers a 100% online Master of Arts in Museum Studies. Earn your degree from a large public research institution rooted in community and tradition. For more information, please visit our website at pacs.ou.edu or call 405-325-1061. It's your degree. Go get it!

## OnCell

### Booth #414

**Contact:** Thomas Dunne  
1160D Pittsford-Victor Rd.  
Pittsford, NY 14534  
**Phone:** 585-419-9844  
**Email:** tdunne@oncell.com  
**Web:** www.oncell.com  
OnCell provides mobile app technologies for cities, museums, parks, and cultural destinations. We offer the most feature-rich app building platform on the market, allowing you to build and manage your own native and web apps, audio tours, and games. Deploy

beacons, connect with visitors long after they've left your site, and capture valuable visitor data from one easy to use platform. Our team has launched over 2,200 projects since its inception in 2006.

## U.S. Army Heritage and Education Center

### Booth #313

**Contact:** U.S. Army Heritage and Education Center  
950 Soldiers Dr.  
Carlisle, PA 17013  
**Phone:** 717-245-3972  
**Email:** usarmy.carlisle.awc.mbx.ahec-ves@mail.mil  
**Web:** www.usahec.org  
The U.S. Army Heritage and Education Center (USAHEC) is the premier research facility for U.S. Army history dedicated to telling the Army story... one soldier at a time through the collection of U.S. Army soldiers' stories of all ranks and eras. The museum is free, open to the public, and includes immersive and interactive exhibits featuring artifacts from the beginnings of the U.S. Army through current operations. Additionally, the USAHEC's archival collection boasts 16 million items, which are available to the public and can be browsed online.

## U.S. Citizenship and Immigration Services

### Booth #211

**Contact:** Nadia McFarlane  
131 M St., NE 7th Floor  
Washington, DC 20529  
**Phone:** 202-357-7930  
**Email:** nadia.mcfarlane@uscis.dhs.gov  
**Web:** www.uscis.dhs.gov  
U.S. Citizenship and Immigration Services (USCIS) is the government agency that oversees lawful immigration to the United States.

## Wide Awake Films

### Booth #402

**Contact:** Brian Rose  
315 Delaware  
Kansas City, MO 64105  
**Phone:** 816-872-3456  
**Email:** brian@wideawakefilms.com  
**Web:** www.wideawakefilms.com  
We are a team of producers, writers, cinematographers, animators, and editors. We search for the heart of the story and work tirelessly until it's told. As a full-service video production studio, we're able to handle all of your needs in-house, including conceiving, script writing, cinematography, editing, video animation, and even virtual reality.



# NEW MUST-HAVES

FROM YOUR PROFESSIONAL ASSOCIATION

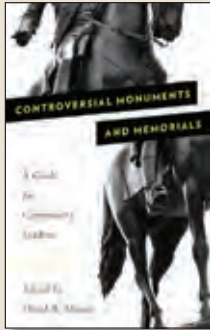

“With a mix of philosophical and practical advice, the authors address today’s relevant issues about race, memory, and history. Even if your community has not yet faced this conflict, it will and you will want this book on your shelf.”

—Melanie A. Adams,  
*Minnesota Historical Society*

August 2018 • 328 pages  
978-1-5381-1373-8 • \$35.00 • Paper  
978-1-5381-1374-5 • \$33.00 • eBook



“A useful guide for museum professionals in these challenging times. . . . This is a must read for those looking for inspiration on how to build inclusive museums with dynamic and relevant programming.”

—Kate Whitman, *Atlanta History Center*

Series: *Interpreting History*  
2018 • 150 pages  
978-1-4422-6324-6 • \$32.00 • Paper  
978-1-4422-6323-9 • \$75.00 • Cloth  
978-1-4422-6325-3 • \$30.00 • eBook

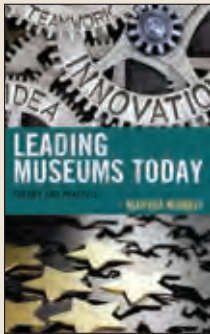

Readers will learn about leadership theory in both for profit and nonprofit worlds and how to effectively master the role of both leader and follower. The book explores the reality of change in the workplace, the standards and best practices of businesses and museums, and innovative approaches to creating a nimble and responsive organization.

2018 • 238 pages  
978-1-4422-7533-1 • \$35.00 • Paper  
978-1-4422-7532-4 • \$79.00 • Cloth  
978-1-4422-7534-8 • \$33.00 • eBook



“A complete do-it-yourself guide for students and seasoned museum professionals. John Summers compiled a career’s worth of exhibition experience into an enjoyably readable volume. It’s all there: conceptualization, communication, content, contracts, construction, and community engagement.”

—Joel Stone,  
*Detroit Historical Society*

2018 • 216 pages  
978-1-4422-7936-0 • \$40.00 • Paper  
978-1-4422-7935-3 • \$90.00 • Cloth  
978-1-4422-7937-7 • \$38.00 • eBook



“Offers solid, practical advice about raising funds from granting sources, be they private and community foundations or local, state and federal governments. With extensive real-life examples of how museums build successful funding relationships, along with new insider information from museum and funder staff, Sutton provides easy-to-understand, step-by-step guidance for making the best funding match, building funder relationships, developing the most compelling funding request, and managing successful awards.”

—Anne W. Ackerson, *Council of State Archivists and the Museum Association of New York*

2018 • 194 pages  
978-1-4422-7310-8 • \$32.00 • Paper  
978-1-4422-7309-2 • \$75.00 • Cloth  
978-1-4422-7311-5 • \$30.00 • eBook

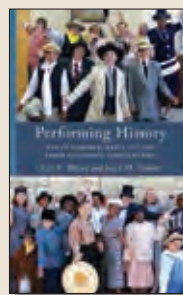

“*Performing History* is infused with the joyful creativity that Ann and Joyce have consistently brought to historical performance for many decades. Whether you are a beginning performer, a seasoned one, or a presenter, you will find a wealth of helpful tips and inspiration for your work here.”

—Bill Adair, *The Pew Center for Arts & Heritage*

2018 • 266 pages  
978-1-4422-7890-5 • \$35.00 • Paper  
978-1-4422-7889-9 • \$79.00 • Cloth  
978-1-4422-7891-2 • \$33.00 • eBook

AASLH members always get **20% off** when ordering AASLH Book Series titles. Use this promotional code at checkout: **AASLHMBR20** when calling Rowman & Littlefield Customer Service at 1-800-462-6420 or at [www.rowman.com](http://www.rowman.com).

ROWMAN &  
LITTLEFIELD  
[www.rowman.com](http://www.rowman.com)

# Tours

These events are not included in the Annual Meeting registration fee and require preregistration. Please see the registration desk for details.

## WEDNESDAY, SEPTEMBER 26

Truman Library



### President for a Day: Walk a Mile in Harry Truman's Shoes

8 am–5:30 pm, Cost: \$70

This tour is educational and interactive, providing a 360-degree experience of President Truman's life in the White House and at home in Independence, Missouri. Visit the Harry S. Truman Presidential Library and Museum for a guided tour of the museum exhibits and experience an immersive, interactive history lab. Then tour the Harry S. Truman National Historic Site to visit the home he shared with his wife and enjoy a reception on the back lawn.

### The Truth about Lawrence, Kansas

8:30 am–5:30 pm, Cost: \$70

Lawrence, Kansas, is a community rich in history, a place where local events have influenced both state and national history, and where national struggles played out on a local scale. This tour highlights the cultural heritage of Lawrence and visits the sites that preserve and tell historical stories of the community, the state, and the nation. Tour venues, many featuring new facilities or exhibits, include Haskell Indian Nations University Cultural Center, the Watkins Museum of History, the University of Kansas Booth Family Hall of Athletics/DeBruce Center, the Kenneth Spencer Research Library, and the Robert J. Dole Institute of Politics. A short walking tour of historic downtown Lawrence will take partici-



pants from the Watkins to the Eldridge Hotel, twice destroyed in pro-slavery raids on Lawrence in 1856 and 1863, where a short tour and lunch will be provided. A guided tour at each venue will explore the institution's history, collections, and exhibits, and offer behind-the-scenes looks at operations and facilities. Participants will hear stories of the fate of American Indian children sent to government-run boarding schools, learn of the founding of KU, experience Quantrill's 1863 raid on Lawrence through first-hand accounts, explore the passage of the Americans with Disabilities Act, and see James Naismith's original rules for the game of basketball.

### Kansas City Treasures

8:30 am–12:30 pm, Cost: \$38

Start your AASLH conference off by visiting three of Kansas City's most iconic museums. The Arabia Steamboat Museum brings life on the 19th-century frontier to life through a remarkably preserved collection of freight recovered from a sunken Missouri River steamboat. When the Arabia sank near Kansas City in 1856, it was loaded with 200 tons of supplies bound for settlements such as St. Joseph, Omaha, and Sioux City. Everyday needs of settlers are seen in the necessities found onboard such as bottled food, tools, clothing, and over 4,000 shoes. The National Museum of Toys and Miniatures, renovated in 2015, features permanent exhibits that explore the art of the imagination. Exhibits include the temporary exhibit *Playing for Keeps: The VFW Marble Tournaments, 1947-1962* and *Toys from the Attic: Stories of American Childhood* that shows the development of children through well-loved toys. Finally, visit the Kansas City Museum at the Historic Garment District which offers special exhibitions that display historical items from their collections and also presents contemporary works by local fashion designers, entrepreneurs, and artists.



Patee House Museum

## Business History of Kansas City

1–5:30 pm, Cost: \$38

Explore the history of business in Kansas City. Stops will include a behind the scenes tour of Hallmark's corporate archives and The Federal Reserve Bank of Kansas City. Each business has extensive collections with public outreach museums. Join this tour, sponsored by the AASLH Business History Affinity Group, to learn how these repositories serve both their internal departments and the public with their research and displays. *Note: A photo ID will be required for this tour.*



The Black Archives of Mid-America



2018 AASLH Fun Run

## Johnson County History: From Settlement to Suburbs

1:30–5:30 pm, Cost: \$38

Participants will visit three sites, moving chronologically through the history of Johnson County, Kansas, a suburb of Kansas City. The tour will begin with a visit to the Shawnee Indian Mission to explore the relocation of Native American tribes, white settlement in the area, and the 1839 Manual Labor School. Move forward in time

to the 1860s at the Mahaffie Stagecoach Stop & Farm. Ride a real stagecoach and explore farm life on the Kansas frontier. Fast forward to Shawnee Town 1929 to explore truck farming on the outskirts of Kansas City in a dynamic period of history.

## THURSDAY, SEPTEMBER 27

### Run (or Walk) Your Way Into History

6:30–8:30 am, Cost: \$35

Run or walk your way into history at the 2018 AASLH Fun Run. On the beautiful grounds of the National WWI Museum and Memorial, two courses are available—one with hills to challenge the fittest among us, and a smooth, flat course for those who want a less strenuous challenge. And if you really want a workout, run a self-directed course up and down the steps to the monument—it's wicked.

### The Consequences of Time and the Truth of Creative Building Reuse: A Walking Tour of the Crossroads Arts District

7–8:30 am, Cost: \$20

Kansas City's Crossroads District reemerged in recent decades as a lively arts district, but it also boasts a fascinating past. Among the most interesting aspects of the Crossroads is the way that past and future merge here, especially through the creative reuse of the district's historic buildings. Hosted by the Missouri Humanities Council and led by architectural historian Cydney Millstein, this 1.5-mile tour will give insight into the history of five Crossroads buildings, their modern re-uses, and the processes of preservation. The tour will begin with an overview of Crossroads history. From there, see the TWA/Barkley building, then the Vitagraph Building, followed by the Rieger Hotel. The tour will make an extended stop at Messenger Café, where participants will hear about the building's repurposing and enjoy some of Kansas City's best coffee and pastries. Finally, finish at the Main Street Theater (Alamo Drafthouse).

## From Slavery to Freedom: Emancipation and Escape in Antebellum Homes

1:30–4:30 pm, Cost: \$38

Pre-Civil War Missouri slaveholding households closely resembled family farms rather than large Southern plantations. Because Missouri farms operated on a much smaller scale, enslaved people lived and worked in close proximity to the white family and hired workers and were often "hired out" to work for neighbors with wages that lined the pockets of slave owners. As slavery disintegrated in Missouri in the midst of the Civil War, many enslaved people took the opportunity to escape while others chose to stay. Explore the Harris-Kearney House, the John Wornall House, and the Alexander Majors House, and learn how each of these unique museums interpret the stories of the Civil War, slavery, emancipation, and the building of the West.

## American Creative: Thomas Hart Benton

1:30–5:30 pm, Cost: \$38

As one third of the American Regionalists (along with John Steuart Curry and Grant Wood), artist Thomas Hart Benton (1889-1975) was once one of this country's most popular contemporary artists. Benton, a champion of rural life and the common man, was also Kansas City's controversial creative, painting satires of American culture in a style that rankled the art establishment. This tour will take you to his home and studio, the Kansas City Art Institute where he taught for decades, and the celebrated Nelson-Atkins Museum of Art, home to the largest public collection of his works. The tour will examine his work, his life, and his legacy, at times both brilliant and problematic.

## FRIDAY, SEPTEMBER 28

### The Story of Segregation in Kansas City

8:30 am–12:30 pm, Cost: \$38

Focusing on landmarks pertinent to the story of segregation, integration, and the failures of integration in Kansas City, this tour will expose participants to a new perspective on the racial landscape of the city by examining the history of racial segregation. The tour, developed for the general public by the Johnson County Public Library, asks participants to consider "Why do we live where we live?" and "How has race, wealth, and real estate shaped the neighborhoods of Kansas City and Johnson County?" By placing these questions in the historical context of segregation, the bus tour encourages open and honest dialogue between participants and allows them to understand Kansas City's history of segregation in order to critique the present and build for a better future.

# Tours



18th and Vine

## SATURDAY, SEPTEMBER 29

### 18th and Vine Historic District

7:30 am–12 pm, Cost: \$38

The 18th and Vine District was primarily known for its commercial value and entertainment centers such as nightclubs and dance halls that helped this area become a prominent location for jazz development in the 1920s. The influence of Tom Pendergast's "wide open" city allowed nightclubs to remain open during Prohibition. The Kay-Cee style of jazz that developed during this time has been attributed to Count Basie and Charlie Parker. The black population in Kansas City increased between 1900 and 1940, primarily due to the Great Migration from southern rural communities. This area became known as a mecca for black businesses which included Ol' Kentucky BBQ, Roberts' Motor Mart, the Street Hotel and Lincoln Building which housed many doctors, dentists, lawyers, and other professionals. In addition to a walking tour led by the Black Archives of Mid-America, the tour will include a stop at the Negro Leagues Baseball Museum.

### A Day in St. Joseph

8 am–5:30 pm, Cost: \$70

St. Joseph, Missouri, was once the westernmost edge of the United States, the last stop before pioneers crossed the Missouri River into Indian territory and where you can find the beginning of the Pony Express and the end of the notorious

Jesse James. With more museums per capita than Washington D.C., St. Joe is the perfect place to explore local, state, and iconic American stories. Combining the American West with stories of some of the most renowned American geniuses, our museums invite you to take a trip north of downtown Kansas City and learn about these stories and more!

### Find Your Independence!

8:30 am–5:30 pm, Cost: \$70

Independence has been the starting point for epic adventures for generations. From the early days of the Latter-day Saints movement to the Oregon Trail to President Truman, this city has seen two centuries of history. Visitors on this tour will experience all the history Independence has to offer. Starting at one of the oldest homes in the area, the Bingham Waggoner Estate shows how the city has changed over time. Move to the National Frontier Trails Museum to learn more about the trail systems through Independence, and the Chicago & Alton Depot, to learn about modes of transportation during the 19th century. Tour the Community of Christ Temple and to learn of its architecture and the rich religious roots of the city. The 1859 Jail Museum details the history of frontier justice and introduces visitors to a wide array of characters that lived in the home.

For lunch, guests will eat at Courthouse Exchange, which has been on the Independence Square since the late 1800s. For dessert, walk across the street to Clinton's Soda Fountain, where a young Harry Truman worked his first job. After lunch, you will experience the Historic Truman Courthouse, which has stood on the lawn for nearly 200 years. The Vaile Mansion is the height of Victorian elegance, and you can experience the beautiful grounds and home. You will end the day by crafting your very own hand puppet at the Puppetry Arts Institute, dedicated to preserving and promoting puppetry.



Vaile Mansion

### Truth and Consequences: Civil War on the Western Border

8:30 am–5:30 pm, Cost: \$70

The Civil War in western Missouri and eastern Kansas did not start in 1861 with the firing on Fort Sumter, but in 1854 with the passage of the Kansas-Nebraska Act. Explore this territory of firsts: the first armed skirmish between pro-slavery and abolition forces, the first violent actions of John Brown, the first engagement of African American troops during the Civil War, and the first time the U.S. Army ordered the evacuation and destruction of property of American citizens. Learn about the history of the area and the stories of the communities who invested in preserving these sites and telling the story. Tour stops include the Burnt District Monument, Bates County Museum, Battle of Island Mound State Historic Site, Marais des Cygnes Massacre State Historic Site, Mine Creek Battlefield State Historic Site, John Brown Museum State Historic Site, and Black Jack Battlefield and Nature Park.



American Jazz Museum

# SPECIAL EVENTS

These events are not included in the Annual Meeting registration fee and require preregistration. Please see the registration desk for details.



Johnson County Arts & Heritage Center

## Suburbia Unleashed Wednesday, September 26

6:30–9:30 pm

Cost: \$45, Preregistration Required

Join us for an evening of art, music, theater, and history at the Kansas City region's newest cultural venue in the Kansas suburbs! Opened in 2017, the Johnson County Arts & Heritage Center is a recently renovated mid-century modern icon turned cultural community center. The Johnson County Museum unpacks the history of the city from the suburban perspective. Tour a 1950s All-Electric suburban ranch home juxtaposed against the realities of racial discrimination in housing and education. Sneak a peek at final rehearsals of Lin-Manuel Miranda's *In the Heights*. Visit with visual artists and view their work. The evening offers ethnic fare from local restaurateurs, beers and wines, and live music!

## Sunset at the National World War I Museum and Memorial

Thursday, September 27

6:30–9:30 pm

Cost: \$49, Preregistration Required

Enjoy an evening of entertainment, great food, and drinks at one of the most iconic landmarks of Kansas City. The National WWI Museum and Memorial welcomes you to spend time with friends and make new ones, while enjoying the galleries including a special exhibition focusing on the American Jewish WWI experience. As the sun sets, take in the best views of Kansas City from the imposing Liberty Memorial Tower.

## Leadership in History Awards Banquet

Friday, September 28

6:30–9 pm

Cost: \$75

Join AASLH in honoring the best in state and local history at the 2018 Leadership in History Awards. The evening will include dinner, a performance from a National History Day winner, and a lively awards presentation.



National World War I  
Museum and Memorial

# WEDNESDAY

## SEPTEMBER 26



Harry Truman Memorial

## PRE-MEETING WORKSHOPS

These events are not included in the Annual Meeting registration fee and require preregistration. Please see the registration desk for details.

### FULL-DAY WORKSHOPS

8:30 am–5 pm

#### Career Growth Studio **ST**

Cost: \$75

► Room: BH 2209

Are you at sea in your career's wide ocean? Need to find your bearings or set your course for an invisible shore? Learn, develop, and hone some effective strategies as you navigate your career beyond the entry-level. Where do you want to go next? How do you get there?

**Chair:** Dan Yaeger, New England Museums Association, Arlington, MA; Kristin Gallas, Tsongas Industrial History Center, Lowell, MA

#### To Be More Inclusive: Training and Resources in the Arts and Humanities Field **DI**

Cost: \$40

► Room: BH 2210

How diverse and inclusive is the arts and humanities field in the areas of employment, policies and procedures, and programs/activities? Join this all day pre-conference workshop to receive the necessary training and resources to ensure that diverse viewpoints representing race, ethnicity, culture, disabilities, and sexual identity are integrated and practiced.

**Chair:** Marian Carpenter, The John & Mable Ringling Museum of Art, Sarasota, FL; Omar Eaton-Martinez, Prince George's County Parks & Recreation at M-NCPPC, College Park, MD; Enimini Ekong, Brown v. Board of Education National Historic Site, Topeka, KS

### MORNING WORKSHOPS

8:30 am–12 pm

#### Donor-Focused Fundraising: Letting Research Guide Your Organization's Philanthropy **ST**

Cost: \$45

► Room: BH 2208

How do donors want to be approached regarding philanthropy? Your answer matters. Truth: nonprofit museums and history institutions rely on private funding to maintain their facilities and sustain their programs. The consequences of not utilizing today's research and evidence-based fundraising practices will limit a nonprofit's ability to fulfill its mission.

**Chair:** Debbie Bass, National World War I Museum and Memorial, Kansas City, MO; Matt Beem, Hartsook, Kansas City, MO; Peggy Dunn, Mayor and Community Leader, Leawood, KS; Kent Sunderland, Sunderland Foundation, Overland Park, KS

## Field Services Alliance Meeting <sup>ST</sup>

Cost: Free

► Room: BH 2207

The Field Services Alliance (AASLH Affinity Group) consists of those who provide training and capacity-building services for history organizations and museums. Join FSA members to hear about current trends in the work of field services offices, upcoming programs and services, and how FSA is working towards articulating its impact and outcomes. Visit [aaslh.org/resources/affinitygroups](http://aaslh.org/resources/affinitygroups) for more information.

**Chair: Jeannette Rooney**, Indiana Historical Society, Indianapolis, IN

8:30 am–1 pm

## Leadership Forum: What's Next? Growing Your Career in a Time of Change

Cost: \$115

► Room: BH 2211

Too many museum leaders come to work to solve problems. That's not a bad thing, but too often they haven't worked out how they feel about their own practice of museum leadership. In

a highly interactive format that leverages conversations and emphasizes mental agility and engagement with peers, this year's Leadership Forum looks at the intersection points for museum leaders, organizational culture, and museums and community. Emphasizing how individual career growth mirrors organizational growth, What's Next? Growing Your Career in a Time of Change offers new and experienced museum leaders the opportunity to pause and think about why they do what they do; to interact with and learn from one another, to discuss what works and what doesn't, and to explore how to learn from failure. Participants will emerge better able to address leadership challenges regarding creating and nurturing organizational cultures that stress empathy and equity, fostering leadership at all levels, and examining their own careers as part of a continuum of practice. Forum participants will work in small and large groups, as well as have time for individual reflection and identification of steps for short-, mid-, and long-range action.

**Co-Chairs: Anne Ackerson**, Leading by Design, Troy, NY; **Joan Baldwin**, The Hotchkiss School, Lakeville, CT; and **Greg Stevens**, Johns Hopkins University, Washington, DC

## AFTERNOON WORKSHOP

1:30–5:30 pm

## Demonstrating History's Relevance in Today's World

Cost: \$45

► Room: BH 2208

What does it mean to be relevant? What is the relationship between relevance and value? Through discussion and group interaction we will explore ways to make your institution or site more relevant to your community. We will also learn about tools to help demonstrate the value of history as a discipline.

**Chair: John Garrison Marks, PhD**, AASLH, Nashville, TN; **Aaron Genton**, Shaker Village at Pleasant Hill, Harrodsburg, KY; **Tim Grove**, Grove Historical Consulting, Falls Church, VA

## EVENING EVENT

6:30–9:30 pm

## Suburbia Unleashed

Cost: \$45

See description on page 27.

## Elegant, Powerful, Simple and Secure

Collector Systems is the premiere cloud-based collections management software (CMS) solution for museums, historic homes, foundations, and private collectors – manage your collection securely from any web-enabled device.

**Built-in** Getty AAT, Getty ULAN, ITIS and Chenall's Nomenclature 4.0.

**Track** Exhibitions, loans, consignments, shipments and locations.

**Attach** An unlimited number of images, documents, and media files.

**Create** Customized reports, labels, loan agreements, and condition forms.

**Control** Multi-user access with granular security settings.

**Share** Collections privately or publicly with our Gallery feature, or take full control with our API.

# COLLECTOR SYSTEMS

169 Hudson Street, NY NY • (212) 431-0897 • [www.collectorsystems.com](http://www.collectorsystems.com)

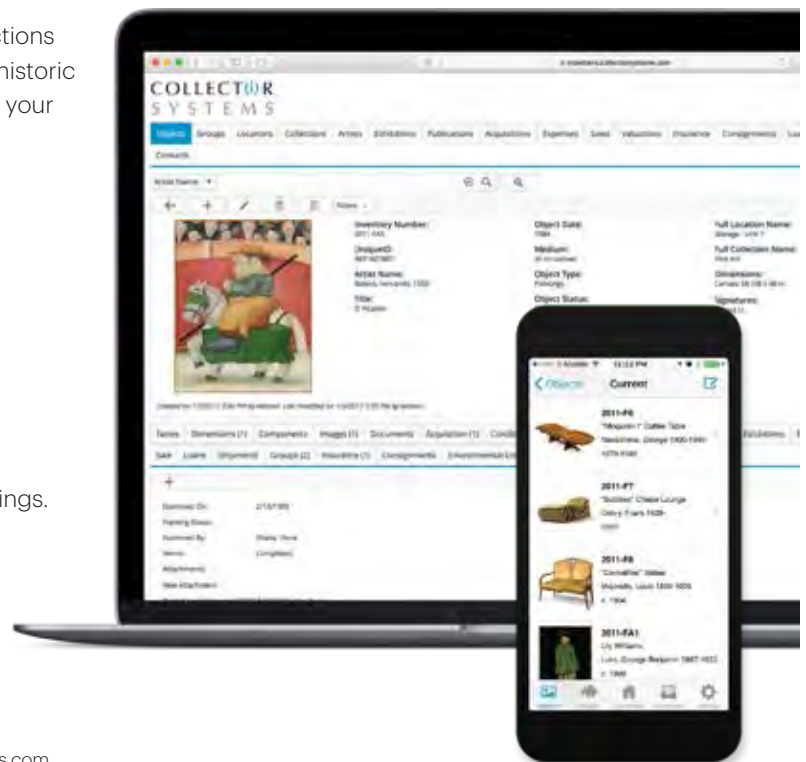

# THURSDAY SEPTEMBER 27



Nelson-Atkins Museum of Art

7–8:15 am

## Historic House Breakfast

Cost: \$35; Preregistration Required

► Room: CC 2502B

Are you on the front lines? Do you want to help solve all the problems with historic houses over one breakfast? Well, you probably can't but we can help you find answers! After state of the field comments, attendees will be broken into small group think tanks to problem solve and strategize the opportunities and challenges facing historic houses. The large group will reconvene to prioritize and draft recommendations that will be shared with the AASLH community.

8:30–9:45 am

**Kick-Off  
Keynote:  
Dan Snow**

► Room:  
CC 3501 A-D



9:45–10:45 am

**Break in Exhibit Hall**

► Room: CC 3501 E-H

9:45–10:45 am

## New Member/First Time Attendee Reception

Cost: Free; Preregistration Recommended

► Room: CC 2502B

Are you or your institution a new member of AASLH? Or is this your first AASLH Annual Meeting? Come learn about what AASLH and the Annual Meeting have to offer and how you can reap the benefits from your membership and your time at the conference. Also, meet fellow AASLH members, along with members of the AASLH Council and staff.

## CASE STUDY SESSIONS

10–10:35 am

### Realistic Collections Moves **CE**

► Room: BH 2201

This session addresses realistic and achievable strategies for moving collections. Move projects are frequent and challenging, which requires museum staff to be creative and innovative. Collections moves can be efficient, inexpensive, safe, and realistic. Presenters will share advice, tips, resources, and strategies that you can adapt for success.

*Chair: Melissa de Bie, History Colorado, Denver, CO*

### Thinking about How We Think: Field Trips That Promote Museum Literacy **CE**

► Room: CC 2502A

At the Missouri History Museum, the key to creating museum literate learners is metacognition: thinking about your own thinking. The strategy makes museum learning transparent and accessible. This case study will examine how museum literacy skills are taught and deconstructed on tours, and the effect on students and educators.

*Chair: Sarah Sims, Missouri Historical Society, St. Louis, MO*





## CONCURRENT SESSIONS

10:45 am–12 pm

### America's Courts: A Place of Truth and Consequences

HR

► Room: BH 2202

Bust out the popcorn! Small group discussions will occur after viewing excerpts from two documentary films produced by federal courts in Kansas (*Americans by Choice*) and Indiana (*And Justice for All*). The discussion will focus on the making of the films and using film to educate the public about the role courts played and still play in welcoming and protecting all citizens.

**Chair:** *Elizabeth R. Osborn, PhD*, Indiana University Center on Representative Government, Bloomington, IN; *Doria Lynch*, U.S. District Court for the Southern District of Indiana, Indianapolis, IN; *Ray Waters*, U.S. District Court, District of Kansas, Kansas City, KS

### Crowdsourcing Slavery Interpretation Challenges

CE

► Room: CC 2505A

With nearly a century of combined experience to draw on, this panel will address interpretive conundrums surrounding slavery or its legacies that YOU bring to the conference. Email your site's problem to [Kristin@interpretingslavery.com](mailto:Kristin@interpretingslavery.com). The panel will facilitate a brainstorming session with the audience to help find a solution.

**Chair:** *Kristin Gallas*, Tsongas Industrial History Center, Lowell, MA; *Christian Cotz*, James Madison's Montpelier, Orange, VA; *Linnea Grim*, Thomas Jefferson's Monticello, Charlottesville, VA; *Richard Josey*, Collective Journeys, LLC, Maplewood, MN; *Joseph McGill*, The Slave Dwelling Project, Ladson, SC

### Detroit67: Looking Back to Move Forward—Truth Leads to Transformation

DI

► Room: CC 2504A

In searching for ways to discover and display the truths behind the causes and consequences of the racially charged conflict of July 1967, the Detroit Historical Society developed a cross-disciplinary project model that can be applied by historical organizations of any size or resource level to similar issues. Presenters will discuss the impact this initiative had on the community as well as on the organizational culture within the historical society.

**Chair:** *Joel Stone*, Detroit Historical Society, Detroit, MI; *Kalisha Davis*, Detroit Historical Society, Detroit, MI

### From the Ground Up: Creating and Building a Culture of Evaluation

ST

► Room: BH 2208

How can you go from having no evaluation to creating a culture of evaluation? This session will explore three internal evaluators and how their positions came to be, how they have built evaluation capacity in their museums, consequences of evaluating and not evaluating, and ways to start incorporating evaluation into your own work.

**Chair:** *Sena Dawes*, Missouri Historical Society, St. Louis, MO; *Patience Baach*, The Field Museum, Chicago, IL; *Katherine Wood*, Minnesota Historical Society, St. Paul, MN

### New Eyes on Old Stories: Challenging Traditional Narratives to Uncover Deeper Truths

CE

► Room: CC 2505B

Why should we re-examine the “truths” our museums interpret? How does the incorporation of new scholarship or previously omitted perspectives necessitate reconsideration of the ways we tell the story? Find out how funding from the National Endowment for the Humanities is helping Plimoth Plantation and the Alice Austen house challenge common perceptions of history.

**Chair:** *Patricia Brooks*, National Endowment for the Humanities, Washington, DC; *Victoria Munro*, Alice Austen House, Staten Island, NY; *Richard Pickering*, Plimoth Plantation, Plymouth, MA

### On the Road: Doing Midwestern LGBTQ History in Traveling Exhibitions

DI

► Room: BH 2207

LGBTQ history is an important, complex, and sometimes unwelcome part of communities' pasts. Representatives from University of Missouri-Kansas City, Indiana Historical Society, and Mid-Continent Public Library will explain how historians have interpreted various hidden histories, describe ways for executing a traveling exhibit, and cover the exhibits' qualitative and quantitative impacts.

**Chair:** *Taylor C. Bye*, University of Missouri-Kansas City, Kansas City, MO; *Karen DePauw*, Indiana Historical Society, Indianapolis, IN; *Dylan Little*, Mid-Continent Public Library, Independence, MO; *Kenneth C. Turino*, Historic New England, Haverhill, MA

### Whiskey for My Staff and Beer for My Llamas: Corporate Partnerships

CE

► Room: BH 2203

Corporate relationships can be more than just dollars, but may require stepping outside our comfort zone. Explore unique corporate partnerships from the nitty-gritty of contract negotiations to building staff buy-in to final implementation.

# THURSDAY, SEPTEMBER 27

Dallas Heritage Village, West Overton Village, and the Dr. Pepper Museum will share their unique stories.

**Chair:** *Melissa Prycer*, Dallas Heritage Village, Dallas, TX; *Jessica Kadie-Barclay*, West Overton Village and Museum, Scottsdale, PA; *Joy Summar-Smith*, Dr. Pepper Museum & Free Enterprise Institute, Waco, TX

## Will Deaccessioning Really Save Your Museum? **ST**

► **Room:** BH 2214

Standards surrounding the use of funds from the sale of deaccessioned objects were established almost thirty years ago. Presentation of legal and ethical principles behind the standards and examination of larger issues of governance, civic responsibility, and sustainability will precede a discussion about whether the standards are still relevant today.

**Chair:** *Sally Yerkovich*, The American-Scandinavian Foundation, New York, NY; *Lori Breslauer*, The Field Museum, Chicago, IL; *Jennifer Landry*, City of Irving, Irving, TX

## AFFINITY GROUP LUNCHEONS

12:15–1:30 pm

These events are not included in the Annual Meeting registration fee and require preregistration.

### Educators and Interpreters

Cost: \$40

► **Room:** CC 2502A

Join the Educators and Interpreters Committee for lunch, networking, and discussion. Get a chance to meet other professionals, contribute to a lively lunch discussion, and learn more about the work of the Educators and Interpreters Committee.

### Religious History

Cost: \$40

► **Room:** BH 2211

Join the AASLH Religious History Group as we learn about Unity, a non-denominational spiritual organization headquartered at Unity Village, located fifteen miles from downtown Kansas City. Dr. Mark Scherer, Unity archivist, will share information on the history and current ministries of the group, influenced by the New Thought movement and founded by Charles and Myrtle Fillmore in 1889 as a healing ministry based on the power of prayer and thoughts.

### Small Museums

Cost: \$40

► **Room:** CC 2502B

Tackling the redesign of permanent exhibits is a daunting task for most of us. Where do you begin? And how do you get it done? Steve Nowak from the Watkins Museum of History will share their story of a massive exhibition overhaul. Learn more about how they reached out to the community to shine a light on stories that are often overlooked.

### Women's History

Cost: \$40

► **Room:** BH 2210

When you're researching women's history, sometimes you have to look in unexpected places. Join the Women's

History Affinity Group and special guest Kimberlee Ried, Public Programs Specialist for the National Archives and Records Administration, for lunch and a presentation on early territorial court cases from Kansas involving women seeking divorces and women inmates who were erroneously incarcerated in Leavenworth Penitentiary.

## CONCURRENT SESSIONS

1:45–3 pm

### Broadcast Yourself **CE**

► **Room:** BH 2208

We all know social media channels can be used to support organizations' education-related goals. But how do you generate engaging content? And, how can you afford it? Learn from seasoned experts: British presenter/history program maker Dan Snow and the team from the National WWI Museum and Memorial.

**Chair:** *Mike Vietti*, National World War I Museum and Memorial, Kansas City, MO; *Dan Snow*, Dan Snow's History Hit, London, England; *Chris Wyche*, National World War I Museum and Memorial, Kansas City, MO; *Jake Yadrich*, National World War I Museum and Memorial, Kansas City, MO

### Consequences Be Damned! Slavery Remembered and the Risk of Acknowledging Hard Truths **HR**

► **Room:** CC 2504A

As historic sites and museums continue to take steps to include the lives of enslaved men, women and children, three organizations serve in helping raise awareness and recognize the enslaved. Delivering such truths does come with some consequences. Hear these professionals talk about their projects and the challenges they've faced.

**Chair:** *Nicole A. Moore*, National Center for Civil and Human Rights, Atlanta, GA; *Ann Chinn*, Middle Passage Ceremonies and Port Markers Project, Jacksonville, FL; *Paul J. Growald*, Stopping Stones Project, Shelburne, VT; *Joseph McGill*, The Slave Dwelling Project, Ladson, SC

### Earned Revenue: Core to Your Institution's Business and Mission **ST**

► **Room:** BH 2202

An institution's relationship with earned revenue can be complicated. Is it possible to make earned revenue part of a site's core business without sacrificing mission and soul? Hear from three museum leaders whose organizations have wrestled with the truth and consequences of earned revenue.

**Chair:** *Ryan Spencer*, The Henry Ford, Dearborn, MI; *Ashley Rogers*, Whitney Plantation, Wallace, LA; *Sean Kelley*, Eastern State Penitentiary Historic Site, Philadelphia, PA

### Field Services Alliance Tips: Scaling Best Practices to Fit Your Organization **ST**

► **Room:** BH 2207

Workshops, webinars, and conferences present ideal best practices in museum management. We learn about projects and lessons learned at large, well-funded institutions, but leave wondering: how can I do this at my small museum? Join us to discuss scalability and how to implement big ideas on an achievable level.

**Chair:** *Samantha Forsko*, Conservation Center for Art and Historic Artifacts, Philadelphia, PA; *Amy Rohmiller*, Ohio History Connection, Columbus, OH; *Jeannette Rooney*, Indiana Historical Society, Indianapolis, IN

## Latino Heritage Conservation DI

► Room: BH 2203

Members of Latin@s in Heritage Conservation will present local and national perspectives on social justice in historic preservation, equity in historic preservation, current challenges in preservation policy, education, and recruitment, alliances with underserved communities, and a vision for a future of historic preservation that connects multiple campaigns for social justice.

**Chair:** Sarah Zenaida Gould, PhD, Latin@s in Heritage Conservation and UTSA Institute of Texan Cultures, San Antonio, TX; Ray Rast, PhD, Gonzaga University, Spokane, WA; Daniel Serda, PhD, inSITE Planning, LLC, Kansas City, KS; Josephine S. Talamantez, Chicano Park Museum and Cultural Center, San Diego, CA

## Reducing Bias in Hiring to Increase Inclusivity DI

► Room: CC 2505A

You've already decided that inclusion is a value and your staff needs to reflect the diversity of your public. How do you change your hiring process to reflect that value? Discover three tools—challenge-based hiring activities, modified interview questions, and internship pathway—to improve recruiting inclusivity.

**Chair:** Stacy Klingler, Butterworth Center & Deere-Wiman House, Moline, IL; Sage Morgan-Hubbard, American Alliance of Museums, Arlington, VA; Natalie Peabody, The Sixth Floor Museum, Dallas, TX; Chris Taylor, Minnesota Historical Society, St. Paul, MN

## What Is Their Truth? What Do People in Kansas City Really Think about History? HR

► Room: BH 2209

Do people in Kansas City care about history? Have we, as a field, done enough to make them want to care? If they don't think history is valuable or critical, why not? What can history organizations do to make history more relevant to their communities?

**Chair:** Conny Graft, Conny Graft Research and Evaluation, Williamsburg, VA; Mindi C. Love, Johnson County Museum, Shawnee, KS

## Winning the Vote: How to Prepare Your Site for a Celebration 100 Years in the Making HR

► Room: CC 2505B

Join us as we discuss the upcoming Centennial of the 19th Amendment in 2020 and its relevance today. What initiatives are already underway? What are the narratives we must confront to grapple with the complexities of the past? How will we engage audiences and build programs to inspire action?

**Chair:** Kelsey Millay, National Woman's Party at the Belmont-Paul Women's Equality National Monument, Washington, DC; Lori Osborne, Frances Willard House Museum, Evanston Women's History Project, and National Collaborative for Women's History Sites, Evanston, IL; Kathleen Pate, Arkansas Women's History Institute, Pine Bluff, AR; Noelle N. Trent, PhD, National Civil Rights Museum, Memphis, TN

## Written and Erased: A Great American Writer, Her Partner, and a Small Nebraska Town HR

► Room: BH 2214

In a new exhibit installed in Red Cloud, Nebraska, an exhibit designer, a museum educator, and a foundation president work to address the sexuality of a great American writer.



Museum professionals involved in the creation of *American Bittersweet: The Life and Writing of Willa Cather* tell their stories.

**Chair:** Nathan Bartel, Flint Hills Design, North Newton, KS; Ashley Olson, Willa Cather Foundation, Red Cloud, NE; Tracy Tucker, Willa Cather Foundation, Red Cloud, NE

1:45 pm–3:45 pm

## Legal History Roundtable at the Whittaker U.S. Courthouse HR

► Location: Meet group at AASLH registration desk to travel to courthouse

Walk to the Whittaker U.S. Courthouse, which features a public gallery and WPA murals of river scenes. It's a great setting to learn more about local legal history and court outreach. A Legal History Group roundtable concludes the session. (Photo ID required; no cell phones/wireless devices due to security regulations.)

**Chair:** Rachael L. Drenovsky, Learning Center Coordinator, Michigan Supreme Court Learning Center, Lansing, MI; Diana Diaz, U.S. District Court, Western District of Missouri, Kansas City, MO; Howard F. Sachs, U.S. District Court, Western District of Missouri, Kansas City, MO

3–4 pm

Break in Exhibit Hall

► Room: CC 3501 E-H

## CASE STUDY SESSIONS

3:15–3:55 pm

## Beyond the Mansion: Interpreting Diverse Stories Across a Historic Property HR

► Room: CC 2502A

In their interpretive planning process, Andrew Jackson's Hermitage asked the question, "What stories are missing or under-told in our current interpretation?" Come see how The Hermitage is learning from audience research and interpretive planning to reconsider how it communicates the complex and diverse experiences of life in the Jacksonian Era beyond the mansion.

**Chair:** Katie Chandler, RK&A, Inc., Alexandria, VA; Erin Adams, Andrew Jackson's Hermitage, Nashville, TN; Ashley Bouknight, PhD, Andrew Jackson's Hermitage, Nashville, TN

## You Want To Get What Done When? Digitizing the Phog Allen Papers ST

► Room: BH 2201

How do you react when a crowdfunding project focused on a significant figure in your university's history is successful? And little physical, intellectual, and conservation work has been done to their collection? University of Kansas libraries staff will discuss lessons learned from digitizing basketball coach Phog Allen's papers.

**Chair:** Marcella Huggard, University of Kansas Libraries-Kenneth Spencer Research Library, Lawrence, KS; Jocelyn Wehr, University of Kansas Libraries, Lawrence, KS

## CONCURRENT SESSIONS

4–5:15 pm

### Advocating for Collections Care Both Internally and Externally **ST**

► Room: BH 2202

This session will explore routes for both external and internal advocacy with a focus on collections care, securing time and funding for preservation initiatives and conservation treatment, and will discuss opportunities for incorporating information about preservation into all institutional advocacy efforts.

**Chair:** *Laura Hartz Stanton*, Conservation Center for Art and Historic Artifacts, Philadelphia, PA; *Jennifer Ortiz*, Utah Division of Arts and Museums, Salt Lake City, UT

### All Are Welcome: Staff Training for Inclusion and Ability Awareness at Museums **DI**

► Room: CC 2505A

Museums want to be inclusive to all, including those with differing abilities. When you think of accessibility or inclusion, do you think of training staff? Have some fun in this session as you learn about ability awareness and how you can train and support all museum staff to practice inclusion.

**Chair:** *Daniel Jones*, Living History Farms, Urbandale, IA; *Caroline Braden*, The Henry Ford, Dearborn, MI; *Paul Greene*, The Inclusion Connection- Together We Play, Waterloo, IA; *Tyler Greene*, The Inclusion Connection- Together We Play, Waterloo, IA

### Confronting Uncomfortable Truths: The American Legacy of Repression and Resistance **HR**

► Room: CC 2504A

Public history institutions have an amazing responsibility to reflect truthful accounts that challenge and inspire their visitors towards a greater understanding of social behavior. This interactive discussion will explore uncomfortable truths through the lens of African American history and experiences in an effort to build a culture of truth.

Public history institutions have an amazing responsibility to reflect truthful accounts that challenge and inspire their visitors towards a greater understanding of social behavior. This interactive discussion will explore uncomfortable truths through the lens of African American history and experiences in an effort to build a culture of truth.

**Chair:** *Christopher Miller*, National Underground Railroad Freedom Center, Cincinnati, OH

### From Assumptions to Intolerance: Addressing Visitors' Misconceptions about Religion **DI**

► Room: CC 2505B

Interpreting religion can be challenging, especially when museum visitors arrive with misconceptions and biases.

Following three case studies from institutions experienced in addressing religious questions based on misinformation, the audience will join in, both by questioning panelists and sharing their experiences related to the truth or consequences of interpreting religion.

**Chair:** *Karen Graham Wade*, Community of Christ Historic Sites Foundation, Los Alamitos, CA; *Petra Alsoofy*, Arab American National Museum, Dearborn, MI; *Lynne Calamia*, Executive Director, Historic Arch Street Meeting House, Philadelphia, PA; *Barbara Walden*, Community of Christ Historic Sites Foundation, West Hartford, CT

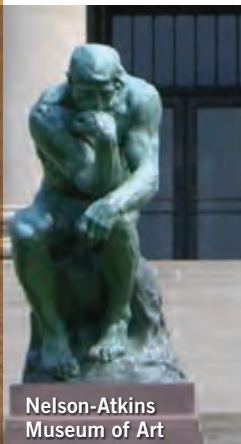

Nelson-Atkins Museum of Art

### Getting Sexy at Historic Sites **CE**

► Room: BH 2207

Let's talk about sex. From physical intimacy to courtship to sex work to changing sexual norms, incorporating the history of sexuality into museums and historic sites allows us to explore questions of societal power, create perspectives on modern sexual politics, and increase audiences. But how can organizations incorporate this topic in a way that is historically accurate and respectful, rather than simply prurient? Join the speakers in a conversation about how to do just that.

**Chair:** *Susan Ferentinos*, Public History Researcher, Writer, and Consultant, Bloomington, IN; *Kaci Johnson*, Bonanzaville Prairie Village, Fargo, ND; *Angela Smith*, PhD, North Dakota State University, Fargo, ND

### Reimagining the Historic House Museum **CE**

► Room: BH 2203

A fundamental trait at successful house museums is a willingness to evolve and change. Presenters will offer new approaches to engage audiences, expand impact, think broadly and manage real-world issues of earned income/sustainability. This session uses examples by the authors in the new AASLH publication, *Reimagining the Historic House Museum*.

**Chair:** *Kenneth C. Turino*, Historic New England, Haverhill, MA; *Lucinda Brockway*, The Trustees of Reservations, Beverly, MA; *Katherine D. Kane*, Harriet Beecher Stowe Center, Hartford, CT; *Lawrence Yerdon*, Strawberry Banke, Portsmouth, NH

### Stories and the Absence of Artifacts: A 360 Degree View of Challenges and Solutions in Creating #1 in Civil Rights: The African American Freedom Struggle in St. Louis **DI**

► Room: BH 2208

Staff members from across the Missouri Historical Society will give a 360-degree view of the challenges presented and the solutions reached in the development of the exhibition *#1 in Civil Rights: The African American Freedom Struggle in St. Louis*, which spans the period of 1819 to the present.

**Chair:** *Elizabeth Pickard*, Missouri Historical Society, St. Louis, MO; *Shakia Gullette*, Missouri Historical Society, St. Louis, MO; *Gwen Moore*, Missouri Historical Society, St. Louis, MO; *Sarah Sims*, Missouri Historical Society, St. Louis, MO

### Truth and Consequences in Developing Programs of Diversity and Inclusion **DI**

► Room: BH 2209

Join this roundtable discussion focusing on ways in which issues of diversity and inclusion intersect with the theme of *Truth or Consequences*. This session is sponsored by the AASLH Educators and Interpreters Committee.

**Chair:** *Megan Wood*, Director, Museum and Library Services, Ohio History Connection, Columbus, OH; *Sarah Jencks*, Ford's Theatre, Washington, DC

### The Wages of History: Emotional Labor on Public History's Front Lines **ST**

► Room: BH 2214

Many public history interpreters enter the field seeing the work as a privilege, but quickly discover its emotional and financial tolls. In conversation with *The Wages of History: Emotional Labor on Public History's Front Lines'* author,



JASON DAILEY



participants will think and talk about working conditions at cultural heritage organizations. This session is sponsored by the National Council on Public History.

*Chair: Amy Tyson, Associate Professor, Department of History, DePaul University, Chicago, IL; Rebecca Shrum, Indiana University-Purdue University, Indianapolis, IN*

## RECEPTIONS

5:30–6:30 pm

### History Leadership Institute

Cost: Free; Preregistration Recommended

► **Room: Marriott Muehlebach Barney Allis Historic Lobby**

Come celebrate the kick-off of the History Leadership Institute! Formerly known as Developing History Leaders @SHA and the Seminar for Historical Administration, 2018 marks a transformation of the field's premier professional development opportunity and its re-envisioning as the History Leadership Institute. Whether you're an alumnus of the program, interested in attending, or just curious what all the buzz is about, come join us for a lively gathering of history professionals focused on the future of the field.

### History Happy Hour

Cost: Free (food and drinks not included)

Looking for a way to network with new colleagues? Many of our affinity groups will be hosting informal meet-ups in the hotel or at nearby restaurants and bars where you can come together and meet people with similar professional interests. Find a list of offerings on the AASLH website, the conference app, or at the conference registration desk.

5:30–7 pm

### Diversity and Inclusion Task Force Mixer

Cost: Free; Preregistration Recommended

► **Room: Marriott 12th Street Room – Lobby Level**

Join AASLH's Diversity and Inclusion Task Force for a time of fellowship. Meet with current members of the task force and other conference attendees, and learn more about how the task force is assisting AASLH staff and council in their efforts to build inclusionary practices into their work and the public history field at large.

## EVENING EVENT

6:30–9:30 pm

### Sunset at the National World War I Museum and Memorial

Cost: \$49

See description on page 27.

**“WE WOULD HIRE THEM AGAIN WITHOUT HESITATION.”**

– **Mindi C. Love**, Museum Director  
Johnson County Museum  
Arts & Heritage Center

Displays  
Exhibits  
Environments



**McCullough**  
CREATIVE

[www.MCDisplays.com](http://www.MCDisplays.com)

Visit us at booth 412!

# FRIDAY

SEPTEMBER 28

Westport Route  
SANTA FE  
OREGON  
CALIFORNIA  
TRAILS  
Crossed Here



Westport Historic Neighborhood

7–8:15 am

## Military History Breakfast

Cost: \$35; Preregistration Required

► Room: BH 2203

Join the AASLH Military History Affinity Group as they network and hear from Doran Cart, Curator at the National World War I Museum and Memorial, discuss commemorations and exhibits.

8:30–9:45 am

## StEPs Friday Morning MeetUP

Cost: \$10; Preregistration Required

► Room: BH 2211

When it comes to removing items from an institution's collection, the devil is definitely in the details. Along with issues of transparency, accountability, and ethics, there are also policies and procedures that should be in place before deaccessioning occurs. Does your institution have a policy that addresses the sale, trade, or disposal of collection items? What else needs to be done to avoid common deaccessioning pitfalls, unethical practices, and PR nightmares? Join us for the annual StEPs Friday Morning MeetUP as we discuss deaccessioning best practices and issues currently facing the museum field. The self-study StEPs program is helping more than 975 small- to mid-sized organizations across the country assess their policies and practices in collections management and other areas

of operation. Whether your organization is already using StEPs or you would like to explore enrolling in the program, you are invited to join us. Continental breakfast included.

## CONCURRENT SESSIONS

8:30–9:45 am

### Civil Rights Beyond the South: The Significance of Missouri in the Black Freedom Struggles of the 1960s

► Room: BH 2209

The civil rights movement of the mid-to-late twentieth century remains a focus of popular fascination, yet few audiences are aware of the wide-ranging goals, participations, and geographical settings that made this movement possible. Using St. Louis, Missouri, as an example, this presentation argues that the "classic," post-World War II civil rights movement of the 1950s and 1960s encompassed local communities outside the regional South—contrary to standard depictions of mid-century black social movements. Further, this presentation suggests that as a "border South" state, Missouri was regionally significant as a battleground between differing forms of white racism and black resistance articulated in both the U.S. South and Midwest. This session is sponsored by the Organization of American Historians as part of the AASLH/OAH History Check-In Series.

Chair: Clarence Lang, PhD, University of Kansas, Lawrence, KS

Session Codes: **CE** Creative and Experimental **HR** History Relevance

## Communicating Across Divides **DI**

► Room: CC 2505B

How can lessons from social psychology help us share the complexity of history and the difficult stories that challenge people? After a brief overview, we'll discuss how social psychology can be applied to some of the most difficult topics and leave with a new framework for understanding our audiences.

**Chair:** Michele Longo, Gadsby's Tavern Museum/Office of Historic Alexandria, Alexandria, VA; Anna Altschwager, Old World Wisconsin, Eagle, WI

## Discovering Truth and Unconscious Bias: A Continued Conversation **DI**

► Room: CC 2505A

How diverse and inclusive is the arts and humanities field in the area of employment, policies and procedures, and programs/activities? This session will be a continuation of the pre-conference workshop, providing training and resources to ensure that diverse viewpoints representing race, ethnicity, culture, disabilities, and sexual identity are integrated and practiced.

**Chair:** Chris Taylor, Minnesota Historical Society, St. Paul, MN; Marian Carpenter, The John & Mable Ringling Museum of Art, Sarasota, FL; Richard Josey, Collective Journeys, LLC, Maplewood, MN

## Pop Up Session

► Room: BH 2210

The topic of this session will be announced via Twitter, the conference app, and on the conference information board, after voting concludes no later than 2 pm on Thursday. For more information, see page 4.

## Ready for Retirement? **ST**

► Room: BH 2207

Is your long-serving CEO retiring? Are you thinking about retiring? Retiring takes planning and strategic thinking—for the executive and for the organization, especially the board. Panelists will share their experiences and suggestions for building positive retirement transitions for the organization and the individuals.

**Chair:** Katherine D. Kane, Harriet Beecher Stowe Center, Hartford, CT

## Telling the Truth about Woman Suffrage: A Roundtable Discussion **HR**

► Room: CC 2502B

If our museums and historic sites are to offer an authentic and diverse narrative for the Centennial of the 19th Amendment in 2020, we need to begin now. In a roundtable format, join your fellow practitioners, historians, and educators to discuss and expand the critical narrative of women's suffrage.

**Chair:** Page Harrington, Page Harrington & Company, Alexandria, VA; Felicia Bell, PhD, Rosa Parks Museum, Montgomery, AL; Rebecca Price, Chick History, Nashville, TN; Noelle Trent, PhD, The National Civil Rights Museum, Memphis, TN

## To Tell the Truth: Teaching Difficult History Through an Exhibit **HR**

► Room: BH 2214

How can a new exhibit stimulate opportunity to innovate programs and create purposeful dialogue? James Madison's Montpelier shares engagement strategies for visitors, teachers, students, and descendants of the enslaved that leveraged Montpelier's challenging, relevant, and emotional exhibit, *The Mere Distinction of Colour*.



Kansas City Public Library

**Chair:** Dina Bailey, International Coalition of Sites of Conscience, Atlanta, GA; Christian Cotz, James Madison's Montpelier, Orange, VA; Kyle Stetz, James Madison's Montpelier, Orange, VA; Emily Voss, James Madison's Montpelier, Orange, VA

## Trends and Lessons from the 2018 Leadership in History Awards **HR**

► Room: CC 2504A

What are the trends in the history field? Join the 2018 Leadership in History award winners for lightning presentations about why their project matters, how it's an example of innovation, and what challenges they overcame. The conversation will conclude with group discussion to identify current trends and success models.

**Chair:** Nicholas J. Hoffman, Missouri Historical Society, St. Louis, MO; Jason Crabill, Ohio History Connection, Columbus, OH

## The Truth about Millennials as Change-Makers in the Workplace **ST**

► Room: CC 2504B

This session will build off of a discussion that began at the 2018 National Council on Public History meeting. It will include a productive discussion around the "truth and consequences" of a public history workforce that is increasingly dominated by millennials. It is vital to explore how millennials reconcile generational differences in the workplace as public historians seek to explore and expose the complexities of history that have previously been left behind. As a younger generation prepares to engage in new methods of historical interpretation, how do sites of history and "truth" maintain public trust?

**Chair:** Alyssa Constad, General Federation of Women's Clubs, Washington, DC

9:45–10:45 am

Break in Exhibit Hall

► Room: CC 3501 E-H

## NCPH Poster Session

► Room: CC 3501 E-H

The National Council on Public History has partnered with AASLH to sponsor this Poster Session. Built on NCPH's model for public history presentations that use visual evidence, presenters will share their work, including works-in-progress, through one-on-one discussion.

## CASE STUDY SESSIONS

10–10:30 am

### More Than Speaking Slowly: Transforming Museum Educational Programs for Bilingual Learners DI

► Room: CC 2502A

Nobody speaks every language, but your museum can speak to all your visitors! This session examines challenges facing bilingual learners and the reasons bilingual teachers hesitate to visit museums. Specific steps to transform programs will be addressed as a case study takes a program from English only to bilingual friendly.

Chair: *Debbie Fandrei*, The Raupp Museum, Buffalo Grove, IL

### Rebels to Roses: Creating a Volunteer Management Program ST

► Room: BH 2208

How do you wrangle 1,000+ volunteers who've been self-managed to the detriment of your organization? Start at the top down, ASAP. Hear how Filoli implemented changes: rewriting by-laws, creating a code of conduct, requiring criminal background screenings, and weeding out troublemakers to reform rebel volunteers into supportive and productive "roses."

Chair: *Susan O'Sullivan*, Filoli, Woodside, CA; *Paula Allen*, Filoli, Woodside, CA; *Kara Newport*, Filoli, Woodside, CA

Bring your exhibits to LIFE.



HANDPAINTED MURALS BY JOHN NEAL  
[WWW.JOHNWNEAL.COM](http://WWW.JOHNWNEAL.COM)

10:45–11:45 am

AASLH Meeting of the Membership

► Room: CC 3501 A-D

AASLH

Make plans to attend this important meeting to learn about what your organization accomplished in the last year and the exciting things coming up in 2019.

Chair: *Katherine D. Kane*, Harriet Beecher Stowe Center, Hartford, CT; *Norman Burns*, Conner Prairie, Fishers, IN; *John Dichtl*, AASLH, Nashville, TN

11:45 am–12:30 pm

### Annual Meeting Attendees Luncheon

Cost: \$10

► Room: CC 3501 E-H

Take time to visit with exhibitors and colleagues in the exhibit hall during this informal lunch provided by AASLH.

## CONCURRENT SESSIONS

12:30–1:45 pm

### Beyond "Slave" and "Mistress": Improving Women's Interpretation at Historic Sites and Museums DI

► Room: BH 2211

What messages or stereotypes do we present of women in our tours and exhibits? Join the Women's History and Historic House Affinity Group for an eye-opening presentation on how race, gender, and material culture are used and interpreted at historic sites. Participants will be introduced to an easy-to-use, newly developed assessment methodology and a field test of the methodology applied to the Atlanta History Center. The session will help sites and museums envision a more complex and complete women's history interpretation.

Chair: *Rebecca Price*, Chick History, Nashville, TN; *Rebecca Shrum*, Indiana University-Purdue University, Indianapolis, IN; *Jessica VanLanduyt*, Atlanta History Center, Atlanta, GA; *Jamie Melissa Wilms*, Denver Firefighters Museum, Denver, CO

### Crumbling Pedestals and Monumental Follies: Truth and/or Consequences After Charlottesville HR

► Room: CC 2505A

This panel offers space for conversation among public history practitioners regarding the consequences of pursuing the truth of monument culture. Geographically diverse viewpoints and contexts demonstrate the many ways that monuments and the timely issues of race, gender, and class continue to be debated and addressed by historians and communities.

Co-Chairs: *David Allison*, Denver Museum of Nature and Science, Denver, CO, and *Laura A. Macaluso*, Independent Professional, Lynchburg, VA; *Wayne Gannaway*, Thomas Jefferson's Poplar Forest, Forest, VA; *Modupe Labode*, Indiana University-Purdue University, Indianapolis, IN; *Elizabeth Pickard*, Missouri Historical Society, St. Louis, MO; *Ben Wright*, University of Texas-Austin, Austin, TX

### Exploring Ken Burns's *Vietnam War*: National and Local Perspectives HR

► Room: BH 2207

This session, sponsored by the AASLH Military History Affinity Group, will examine the opportunities presented by Ken



Burns's 2017 series *The Vietnam War*. Panelists will discuss its usefulness for engaging and presenting to our constituents and critiques from all perspectives. It will also include a local example from the Kansas City PBS and Kansas City Public Library who worked with community partners to create a conversation about the local impact of the war.

**Chair:** *Marc Blackburn*, Mount Rainier National Park, Ashford, WA; *Bill Brewster*, First Division Museum, Wheaton, IL; *Kaite Stover*, Kansas City Public Library, Kansas City, MO

### Inspiring Discomfort with Change: The New Alaska Exhibition at the Anchorage Museum HR

► **Room:** BH 2214

The new Alaska exhibition at the Anchorage Museum, which opened September 2017, replaced the oldest and largest exhibition of Alaska's history and material culture, originally installed in 1986. Inevitably and also resolutely, the new exhibition takes a fresh look and some new approaches to telling the story of Alaska.

**Chair:** *Shina duVall*, Anchorage Museum Association, Anchorage, AK; *Kirsten Anderson*, Anchorage Museum Association, Anchorage, AK; *Aaron Leggett*, Anchorage Museum Association, Anchorage, AK

### Interpreting Controversial Histories through Community Collaboration DI

► **Room:** CC 2505B

How can state and local history professionals build relationships and share authority with diverse audiences, especially when a history of controversy or institutional mistrust exists? This session will explore strategies for success to interpret the complex, controversial past by collaborating with community members and empowering visitors to become historical researchers.

**Chair:** *Rebecca Bush*, The Columbus Museum, Columbus, GA; *Laura Browder*, University of Richmond, Richmond, VA; *Stuart Hinds*, University of Missouri – Kansas City, Kansas City, MO

### Nomenclature Reinvented! Making Access to Historical Evidence Easier ST

► **Room:** CC 2504A

Collections provide important historical evidence, and cataloging must evolve to improve access to them. Learn how *Nomenclature* is evolving from a book-based authority list to a dynamic, web-based, linked open data platform, thanks to AASLH's new partnerships with the Canadian Heritage Information Network and Parks Canada. How will you and your public benefit from this change?

**Chair:** *Heather Dunn*, Canadian Heritage Information Network, Ottawa, Ontario, Canada; *Paul Bourcier*, Wisconsin Historical Society, Madison, WI; *Jennifer Toelle*, Smoky Hill Museum, Salina, KS

### The Road to Success: Exploring the Intersection between Planning and Innovation CE

► **Room:** BH 2209

Drawing from the experiences of recent master planning efforts at Gunston Hall and the Dallas Heritage Village, two executive directors and two experienced planning consultants will discuss their experiences with planning processes, how this integrates with interpretive planning for cultural and historic sites, and their lessons learned in this process.

**Chair:** *Steven Blashfield*, Glave & Holmes Architecture, Richmond, VA; *Melissa Prycer*, Dallas Heritage Village, Dallas, TX

### The Truth about Troost: The Consequences of Engaging Diverse Students in Conversations about Race Based on Local History HR

► **Room:** BH 2210

Kansas City is divided by the state line and by Troost Avenue, a segregation line created in the mid-20th century. Race Project KC is an immersive social justice initiative and curriculum that investigates the history and relevance of that division. Learn about this program from coordinators, educators, and student participants.

**Chair:** *Julie McPike*, Freedom's Frontier National Heritage Area, Lawrence, KS; *Olive Henry*, Shawnee Mission East, Prairie Village, KS; *David Muhammad*, Shawnee Mission East, Overland Park, KS; *Mary Shortino*, Johnson County Library, Overland Park, KS; *Tim Stauffer*, Iola Register, Iola, KS

2–3:15 pm

**Keynote Speaker:**  
**Cheryl Brown Henderson**

► **Room:** CC 3501 A-D



3:15–4 pm Break in Exhibit Hall

► **Room:** CC 3501 E-H

HOURS: TUE, WED, FRI, SAT 10-4 THURS, 10-8, SUN 1-4, CLOSED MON

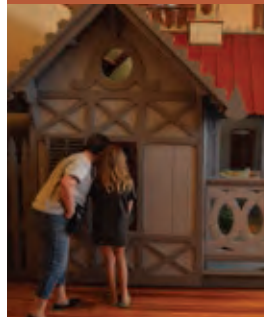

**DISCOVER THE STORIES THAT DEFINE OUR COMMUNITY...**

at the Watkins – where exhibits, interactives, and programs provide fresh experiences for visitors of all ages.



**FREE**  
ADMISSION

**LOOK FOR OUR KIDS' LOGO THROUGHOUT THE MUSEUM FOR KID-FRIENDLY EXPLORATION**



11TH & MASS ST, DOWNTOWN LAWRENCE | 785-841-4109 | WATKINSMUSEUM.ORG

## CASE STUDY SESSIONS

3:25–4 pm

### Extending Avenues of Digital Engagement: Crowdsourcing and the Colored Conventions Project CE

► Room: CC 2502A

This case study examines a crowdsourced research curriculum that engages students in scholarship that resists dominant narratives of nineteenth-century Black political organizing. It highlights the potential for crowdsourced digital public history projects to engage new audiences in the co-creation of historical knowledge by employing innovative pedagogical practices.

**Chair:** Anna Lacy, University of Delaware, Somers Point, DE; Ethan Barnett, University of Delaware, Somers Point, DE

### Innovation and Collaboration: The Secret to Organizational Sustainability and Growth CE

► Room: BH 2208

Innovation and organizational change often requires rethinking priorities and engaging new partners. Discussion will highlight strategy development and lessons learned as the Kansas Museums Association created a unique partnership with the Public Policy and Management Center at Wichita State University to better serve museums, ensure sustainability, and expand educational programs.

**Chair:** Lisa Dodson, Kansas Museums Association, Wichita, KS; Shannon Hsu, Shawnee Town Museum, Shawnee, KS; Robert Workman, Ulrich Museum at Wichita State University, Wichita, KS

## CONCURRENT SESSIONS

4–5:15 pm

### 2040: A Museum Odyssey HR

► Room: BH 2211

To remain relevant, museums must think to the future. That's why we've brought together change-makers and authors featured in AAM's "Museums 2040" issue for a time travel adventure. As good historians do, we'll reveal sources behind the forecasts and invite participants to consider, question, and chart their own museum futures.

**Chair:** Andrea K. Jones, Peak Experience Lab, Brentwood, MD; Omar Eaton-Martinez, Prince George's County Parks & Recreation at M-NCPPC, College Park, MD; Sarah Sutton, Sustainable Museums, Waialua, HI

### Adapting Existing Programs to Serve Language Learners DI

DI

► Room: BH 2207

Learning a language creates opportunities for understanding and empathy. Many of our institutions are surrounded by schools that serve English Language Learners and a growing number of students in Dual Language Immersion programs. Learn how two institutions and an educator are using existing programs to serve these audiences and create new stakeholders.

**Chair:** Alexandra Rasic, Homestead Museum, City of Industry, CA; Cynthia Gertsen, Ford's Theatre, Washington, DC; Jeff Weary, James Bridger Middle School, Independence, MO



### Change Is Hard, Does It Have to Be? ST

► Room: BH 2214

All change is stressful, but for new initiatives to succeed, change must be managed. This session will provide concrete examples of effective change management at historic sites and museums. The facilitators will work with participants to identify behaviors they can practice to more effectively manage change at their own institutions.

**Chair:** Trevor Jones, History Nebraska, Lincoln, NE; Linnea Grim, Thomas Jefferson's Monticello, Charlottesville, VA

### Hire for Culture Or: How I Stopped Worrying and Learned to Love Improv CE

► Room: CC 2504A

We need facilitators with the attitude and skills to truly connect with our guests. So how do we hire the right people and create a culture that lets them learn and cultivate these talents? Hear from two different organizations about how they are shaking up their work culture using improv.

**Chair:** Anna Altschwager, Old World Wisconsin, Eagle, WI; Jennifer Scheyer, Museum of Science and Industry, Chicago, IL

### NAGPRA: The Truth about Repatriation and the Consequences of Returning Collections DI

► Room: BH 2209

The Native American Graves Protection and Repatriation Act (NAGPRA) has had a huge impact on the work and collections of museums, state historical societies, and local agencies of all sizes. This panel will explore the challenges and successes of putting NAGPRA into practice.

**Chair:** Ryan Wheeler, PhD, Robert S. Peabody Institute of Archaeology, Andover, MA; David Barland-Liles, Effigy Mounds National Monument, National Park Service, Harpers Ferry, IA; Sarah O'Donnell, Osage National Historic Preservation, Pawhuska, OK; Melanie O'Brien, National NAGPRA, National Park Service, Washington, DC

### Racism: Is Your Museum Ready to Talk about It? DI

► Room: CC 2505A

How prepared is your museum to talk about race? Many museums over the past year have garnered unwelcome public attention due to racial insensitivity. Using critical race theory and case studies, this session will provide the foundation to begin these conversations as they relate to your programs and practices.



Kansas City's Children's Fountain

**Chair: Melanie A. Adams**, Minnesota Historical Society, St. Paul, MN; **Dina Bailey**, International Coalition of Sites of Conscience, Atlanta, GA

### Tech or No Tech? That Is the Question When Engaging the Next Generation in History CE

► **Room: CC 2505B**

Using technology tools coupled with tangible products, you can power-up your community outreach and engagement for your historic sites. This highly interactive session will support you in expanding your reach to

stakeholders and new audiences. Participants will see live demos and examples that encourage a deep dive exploration into the past.

**Chair: Shannon Haltiwanger**, History Colorado, Denver, CO; **Laura Israelsen**, Chesterfield County Public Schools, Chesterfield, VA; **Michelle Pearson**, Adams 12 School District Century Middle School, Thornton, CO

### Truth or Consequences Lightning Talks HR

► **Room: BH 2210**

Join us for a series of 5-minute lightning talks, presentations about activities at your institution (or in your life) that

relate to the *Truth or Consequences* theme and highlight ways history is relevant in your community. This is a fun, but serious way to share knowledge, expertise, and inspiration.

**Chair: Tim Grove**, Grove History Consulting, Falls Church, VA; **Megan Wood**, Ohio History Connection, Columbus, OH

## RECEPTION

5:30–6:30 pm

### Thank You Reception

Cost: Free; Invitation Only

► **Room: Marriott 12th Street Room – Lobby Level**

Have you taken an extra step to support AASLH with time or money? Then please join us for a special thank you reception where we will celebrate our volunteers, donors, and sponsors. Amid all the business of the Annual Meeting, AASLH staff and Council members want to slow down and get to know you over drinks and light appetizers.

## EVENING EVENT

6:30–9 pm

### Leadership in History Awards Banquet

Cost: \$75

► **Room: CC 3501 A-D**

See description on page 27.



# DORFMAN

## MUSEUM FIGURES, INC.

since 1957

www.museumfigures.com  
800-634-4873

© McKinley Presidential Library

Dorfman Conservation Forms created exclusively with Ethafoam® brand inert polyethylene foam.

# SATURDAY

## SEPTEMBER 29

Dole Institute

### CONCURRENT SESSIONS

9–10:15 am

#### Betting on History and Culture in Las Vegas **HR**

► Room: BH 2207

Over the past decade, cultural institutions in Las Vegas have been strengthened by an increased awareness of and desire for community. This session discusses strategies used by local institutions to reach out to the community to build a sense of place, a sense of history, and a sense of community.

**Chair:** *Jim McMichael*, Las Vegas Convention and Visitors Authority, Las Vegas, NV; *Kelly Luchs*, Las Vegas News Bureau-Las Vegas Convention and Visitors Authority, Las Vegas, NV; *Aaron Micallef*, Springs Preserve, Las Vegas, NV; *Ilana Short*, Nevada State Museum-Las Vegas, Las Vegas, NV

#### Brutal Truths: Making the New Mississippi Civil Rights Museum **DI**

► Room: CC 2502B

“Tell the truth, no matter how brutal.” This directive was given for the new Mississippi Civil Rights Museum. How could a historically oppressive state build community trust to tell an unflinching story of difficult events? By representing multiple and complex perspectives, engaging community participation, and developing innovative exhibition design.

**Chair:** *Jill Malusky*, Hilferty and Associates, Athens, OH; *Lucy Allen*, Mississippi Department of Archives and History, Jackson, MS; *Katie Blount*, Mississippi Department of Archives and History, Jackson, MS; *Pamela D. C. Junior*, Mississippi Civil Rights Museum, Jackson, MS

#### Consequences of Truth for Historic Sites **DI**

► Room: CC 2505A

What is truth and whose truth are we talking about? Weaving truths into the visitor’s experience at historic sites can help reveal and heal past trauma and transform visitor and community engagement, creating a lens through which to view history—one that takes visitors beyond their school textbooks.

**Chair:** *Regine Kennedy*, 106 Group, St. Paul, MN; *Sarah Pharaon*, International Coalition of Sites of Conscience, New York, NY

#### Fulfilling Your Mission When Natural and Manmade Disasters Strike **ST**

► Room: CC 2502A

Emergencies and disasters take many forms, including natural and manmade. Without notice, we are challenged to be nimble and flexible as we strive to fulfill our missions. This session explores prevention, preparedness, and response measures for situations that could happen to us at any time.

**Chair:** *Aaron Genton*, Shaker Village of Pleasant Hill, Harrodsburg, KY; *Susan Fletcher*, The Navigators, Colorado Springs, CO; *Lori Foley*, Heritage Emergency National Task Force, Federal Emergency Management Agency, Lincoln, MA; *Pam Schwartz*, Orange County Regional History Center, Orlando, FL

#### Innovative Museum Leadership: Challenges and Solutions **CE**

► Room: BH 2208

This session will examine innovative solutions to the challenges of leading museums today, in particular, in response to critical issues in their communities. Leaders who have successfully built or transformed their organizations, expanded their programs and facilities, and measured their impact will share best practices with attendees.

**Chair:** *Martha Morris*, George Washington University, Glen Echo, MD; *Erin Carlson Mast*, President Lincoln’s Cottage, Washington, DC; *Marise McDermott*, The Witte Museum, San Antonio, TX; *April Salomon*, Musical Instrument Museum, Phoenix, AZ

#### Interpreting Immigration: Perspectives from Education, Exhibits, and Collections **HR**

► Room: BH 2214

Immigration is a significant—and often, controversial—subject in American history. How can

museums and historical societies interpret this complex subject in a way that is relevant to modern audiences? Learn how immigration and cultural diversity have been interpreted by three different institutions through exhibitions, education, and collections.

**Chair:** *Mary Mikel Stump*, Washington State Historical Society, Tacoma, WA; *Mary W. Madden*, Kansas Museum of History, Kansas Historical Society, Topeka, KS; *Fred Poyner IV*, The Nordic Heritage Museum, Seattle, WA; *Gwen Whiting*, Washington State Historical Society, Tacoma, WA

### Pop Up Session

► Room: BH 2210

The topic of this session will be announced via Twitter, the conference app, and on the conference information board, after voting concludes no later than 2 pm on Thursday. For more information, see page 4.

### U.S. 250th Anniversary Information and Listening Session **HR**

► Room: BH 2209

This session will provide conference attendees an opportunity to learn more about the current plans for the United States' 250th anniversary in 2026, and to share their thoughts and ideas about the commemoration with representatives from major coalitions and initiatives involved in the process.

**Chair:** *Sara Cureton*, Director, New Jersey Historical Commission, Trenton, NJ; *Jim Campi*, Chief Policy and Communications Officer, American Battlefield Trust, Washington, DC; *Jon Grabelle Herrmann*, USA250, Philadelphia, PA; *Gavin Kleespies*, Massachusetts Historical Society, Boston, MA; *Matthew Naylor*, National World War I Museum and Memorial, Kansas City, MO

10:15–10:30 am Break in Foyer

## CONCURRENT SESSIONS

10:30 am–12 pm

### 2019 Annual Meeting Roundtable **CE**

► Room: BH 2210

The program committee for the 2019 Annual Meeting in Philadelphia wants to hear your ideas for making the next meeting better. What did you like about the Kansas City meeting? What should we have done differently? Members of the 2019 Annual Meeting program and host committees should attend. All meeting participants are welcome.

**Co-Chairs:** *Jackie Barton*, Director, Historic Sites and Facilities, Ohio History Connection, Columbus, OH; *David Young*, Delaware Historical Society, Wilmington, DE

### A Tale of Two Cities: Building Museums That Are Community Centers, Not Monuments to the Past **CE**

► Room: BH 2214

Learn from small history museums in two cities that are both developing new museum buildings, both with new exhibition models. Attendees will acquire ideas from the approaches these two museums with limited staff and operating budgets are taking to create thriving inclusive community centers that are not stereotypical historical societies.

**Chair:** *Janice Klein*, Director, EightSixSix Consulting, Tempe, AZ; *Jennifer Landry*, City of Irving, Irving, TX; *Nate Meyers*, City of Chandler, Chandler, AZ

### The Expanding Role of Museums in Adult Citizenship Education **DI**

► Room: BH 2208

This session explores the potential opportunities for museums to expand educational services to immigrants in their communities who are preparing for naturalization. The discussion includes topics such as citizenship education program design, adapting exhibits, resources for lower-level English proficiency adults, and identifying partnerships with government institutions and community-based organizations.

**Chair:** *Kelton Williams, PhD*, Division of Citizenship Education and Training, U.S. Citizenship and Immigration Services, Department of Homeland Security, Washington, DC; *Magdalena Mieri*, National Museum of American History, Washington, DC; *Angelica Docog*, UT-San Antonio Institute of Texas Cultures, San Antonio, TX

### Food in the Gallery? **CE**

► Room: BH 2207

What comes to mind when you hear the phrase “food in the gallery?” This panel will address the importance of interpreting food in museum exhibits, the risks involved in displaying “edible” artifacts, and a discussion on rethinking traditional rules of “No Food or Drink in the Museum.”

**Chair:** *Mary W. Madden*, Kansas Museum of History, Kansas Historical Society, Topeka, KS; *Michelle Moon*, Lower East Side Tenement Museum, New York, NY

### The Inclusive Historian's Handbook: A Conversation with the Editors **DI**

► Room: CC 2505A

The co-editors and advisory committee for *The Inclusive Historian's Handbook* will solicit ideas and suggestions about this collaborative, open-access digital resource, currently in development. They will share a working list of entries, discuss the goals and design of the project, and invite feedback from the audience.

**Chair:** *William S. Walker*, Cooperstown Graduate Program, SUNY Oneonta, Cooperstown, NY; *Modupe Labode*, Indiana University-Purdue University, Indianapolis, IN; *Ashley Rogers*, Whitney Plantation, Wallace, LA; *Kimberly Springle*, Charles Sumner School Museum & Archives, Washington, DC; *Robert Weible*, Historian, Albany, NY

### Locating and Interpreting the Missouri Trail of Tears **HR**

► Room: BH 2209

The Missouri Humanities Council and the National Trail of Tears Association are undertaking a comprehensive research project to identify the Trail of Tears routes through Missouri, including the identification and interpretation of pertinent sites along the route and the creation of an extensive GIS.

**Chair:** *Dr. William S. Belko*, Missouri Humanities Council, St. Louis, MO; *Christopher W. Dunn, JD*, GeoVelo, LLC, Columbia, MO; *Eva Dunn*, Bollinger County Library, Marble Hill, MO; *Troy Wayne Poteete*, National Trail of Tears Association, Webbers Falls, OK; *Mark Spangler*, LaCledde County Historical Society, Lebanon, MO

### The Power of Puzzles **CE**

► Room: CC 2502A

Discover the power of puzzles in engaging people of all ages in historical investigation. Attract and energize new audiences to your museum or historical site using budget-friendly and adaptable escape room inspired programs. Put on your thinking caps and come puzzle over puzzles!

**Chair:** *Amber Kraft*, National Archives and Records Administration, Washington, DC; *Allison Campbell*, Fort Nisqually Living History Museum, Tacoma, WA; *Christina Hanson*, National Archives and Records Administration, Washington, DC

## LABS

1–5:30 pm

Cost: \$35; Preregistration Required

### Digital Show and Tell: Innovative (and Low-Cost) Tools for Engaging New Audiences **CE**

► Room: BH 2211

Many digital tools exist for organizations to engage with diverse audiences at little or no cost. This workshop focuses on real-world examples from institutions, with suggestions and hands-on demonstrations on how to create a collections database, build interpretive tools allowing users to interact with your content, crowdsource research, and even create virtual reality tours.

*Chair: Liesl Christman, National World War I Museum and Memorial, Kansas City, MO; Stacie Petersen, National World War I Museum and Memorial, Kansas City, MO*

### Inside the White House: The Decision Experience **HR**

► Location: Harry S. Truman Presidential Library

The butterfly effect of decisions in our everyday lives pales in comparison to the impact the actions of our world leaders have on all of us. One afternoon at the Harry S. Truman Pres-

idential Library and Museum will introduce you to the truth or consequences that defined the President's legacy. Beginning with a guided tour of museum exhibits, you will learn how the first four months of President Truman's administration shaped the world we live in today. Then, you will move downstairs to the recreated West Wing for the White House Decision Center experience. Step into the roles of President Truman and his advisors, work with formerly classified primary source documents, and collaborate to tackle some of history's greatest challenges like whether to use the atomic bomb to end WWII or how to respond to the Communist invasion of South Korea. This innovative history lab will expose you to the high stakes decision making process of negotiating solutions with cabinet members and resolving international conflicts creatively.

### Interpreting World War I: Engaging Audiences in "Overlooked" Histories **CE**

► Location: National WWI Museum and Memorial

World War I set the foundation for the modern world, which can make engaging modern audiences a snap. Have fun learning about the era's enduring impact and discover new approaches to exploring "overlooked" histories with the Education Staff of the National WWI Museum and Memorial.

*Chair: Lora Vogt, National World War I Museum and Memorial, Kansas City, MO*



**Our Network. Your Community.**  
[midwestmuseums.org](http://midwestmuseums.org)

# SPECIAL THANKS

AASLH would like to recognize the many volunteers who contributed their valuable time, energy, and expertise to the success of this year's conference.

*Thank you!*

## PROGRAM COMMITTEE

### Tim Grove, Chair

Grove History Consulting  
Washington, DC

### Melanie Adams

Minnesota Historical Society  
St. Paul, MN

### Anna Altschwager

Old World Wisconsin  
Eagle, WI

### Dina Bailey

International Coalition of Sites  
of Conscience  
Atlanta, GA

### Michelle Banks

African American Firefighter  
Museum  
Los Angeles, CA

### Jackie Barton

Ohio History Connection  
Columbus, OH

### Kat Burkhardt

Carnegie Museum of  
Montgomery County  
Crawfordsville, IN

### Rich Cooper

Conner Prairie  
Fishers, IN

### Ray Doswell

Negro Leagues Baseball  
Museum  
Kansas City, MO

### Linda Endersby

Museum of Art and Archaeology,  
University of Missouri  
Columbia, MO

### Susan Fletcher

The Navigators  
Colorado Springs, CO

### Veronica Gallardo

Casemate Museum  
Fort Monroe, VA

### Jamie Glavic

National Underground Railroad  
Freedom Center  
Cincinnati, OH

### Shakia Gullette

Missouri Historical Society  
St. Louis, MO

### Jim Hodgson

Fort Worth Aviation Museum  
Fort Worth, TX

### Mary Kay Ingenthron

MK Communications  
Kansas City, MO

### Sarah Jencks

Ford's Theatre  
Washington, DC

### Anne Jones

Johnson County Museums  
Shawnee, KS

### Sean Kelley

Eastern State Penitentiary  
Philadelphia, PA

### Patricia Williams Lessane

Avery Research Center  
Charleston, SC

### Stephen Light

Thomas Jefferson Foundation  
Charlottesville, VA

### Mindi Love

Johnson County Museum  
Shawnee, KS

### Rebecca Martin

George Mason's Gunston Hall  
Lorton, VA

### Katie Moon

Missouri Historical Society  
St. Louis, MO

### Diane Mutti-Burke

University of Missouri,  
Kansas City  
Kansas City, MO

### Matthew Naylor, PhD

National World War I Museum  
and Memorial  
Kansas City, MO

### Anne Petersen

Santa Barbara Trust for  
Historic Preservation  
Santa Barbara, CA

### Melissa Prycer

Dallas Heritage Village  
Dallas, TX

### Tracy Quillin

Kansas Humanities Council  
Topeka, KS

### Alexandra Rasic

Workman and Temple Family  
Homestead Museum  
City of Industry, CA

### Kimberlee Ried

National Archives and Records  
Administration  
Kansas City, MO

### Ashley Rogers

Whitney Plantation  
Wallace, LA

### Stuart Sanders

Kentucky Historical Society  
Frankfort, KY

### Ryan Spencer

The Henry Ford  
Dearborn, MI

### Blair Tarr

Kansas State Historical  
Society  
Topeka, KS

### Anna Marie Tutera

Kansas City Museum  
Kansas City, MO

### Lora Vogt

National World War I Museum  
and Memorial  
Kansas City, MO

### Allison Wickens

George Washington's Mount  
Vernon  
Mt. Vernon, VA

### David Young

Delaware Historical Society  
Wilmington, DE

### Don Zuris

Corpus Christi Museum of  
Science and History  
Corpus Christi, TX

## HOST COMMITTEE

### Mindi Love, Co-Chair

Johnson County Museum  
Shawnee, KS

### Matthew Naylor, PhD, Co-Chair

National World War I Museum and  
Memorial  
Kansas City, MO

### Dave Aamodt

National Frontier Trails Museum  
Independence, MO

### Lucinda Adams

The State Historical Society of  
Missouri  
Columbia, MO

### Sarah Bader-King

Wornall Majors House Museums  
Kansas City, MO

### Marissa Baum

American Jazz Museum  
Kansas City, MO

### Elizabeth Gillam Beckett

Clay County Historic Sites  
Kearney, MO

### Jamie Berry

University of Missouri, Kansas City  
Kansas City, MO

### Kathryn Carpenter

Missouri Humanities Council  
St. Louis, MO

### Jane Davis

Linda Hall Library of Science,  
Engineering, and Technology  
Kansas City, MO

### Kristie Dobbins

LeCompton Historical Society  
LeCompton, KS

### Jeremy Drouin

Kansas City Public Library  
Kansas City, MO

### Paul Gutierrez

Kansas City Museum  
Kansas City, MO

### Shannon Hsu

Shawnee Town  
Shawnee, KS

### Katie Keckelsen

Johnson County Museums  
Shawnee, KS

### Margaret Keough

Mid-America Arts Alliance  
Kansas City, MO

### Adrienne Kizer

National World War I Museum and  
Memorial  
Kansas City, MO

### Petra Kralickova

National Museum of Toys and  
Miniatures  
Kansas City, MO

### Mark Livengood

Missouri Humanities Council  
St. Louis, MO

### Debby Ludwig

Harry S. Truman Presidential  
Library and Museum  
Independence, MO

### Julie McPike

Freedom's Frontier National  
Heritage Area  
Lawrence, KS

### Diane Mutti-Burke

University of Missouri, Kansas City  
Kansas City, MO

### Steve Noll

Jackson County Historical Society  
Independence, MO

### Steve Nowak

Watkins Museum of History  
Lawrence, MO

### Jim Ogle

Freedom's Frontier National  
Heritage Area  
Lawrence, KS

### Charlie Pautler

Shawnee Town  
Shawnee, KS

### Kimberlee Ried

National Archives and Records  
Administration  
Kansas City, MO

### Alana Smith

Westport Historical Society/  
Battle of Westport  
Kansas City, MO

### Sonia Smith

Freedom's Frontier National  
Heritage Area  
Lawrence, KS

### Jean Svadlenak

Svadlenak Museum Consulting  
Kansas City, MO

### Blair Tarr

Kansas State Historical Society  
Topeka, KS

### Anna Marie Tutera

Kansas City Museum  
Kansas City, MO

### Mike Vietti

National World War I Museum  
and Memorial  
Kansas City, MO

### Lora Vogt

National World War I Museum and  
Memorial  
Kansas City, MO

### Peter Welsh

University of Kansas  
Lawrence, KS

### Timothy Westcott

Park University  
Parkville, MO

### Amanda Wiltse

Mid-America Arts Alliance  
Kansas City, MO

### Alexis Woodall

Mahaffie Stagecoach Stop and Farm  
Olathe, KS

# AASLH acknowledges and appreciates the extraordinary support of our Institutional Partners!

Platinum Partner



## MISSOURI HISTORICAL SOCIETY

Premiere Partner



### Partners



Alabama Department of Archives  
and History  
Montgomery, AL



Association of Village Council Presidents  
Bethel, AK



Atlanta History Center  
Atlanta, GA



Avery Research Center for African American  
History and Culture  
Charleston, SC



Belle Meade Plantation  
Nashville, TN



Billings Farm & Museum  
Woodstock, VT



Bullock Texas State History Museum  
Austin, TX



Butterworth Center & Deere-Wiman House  
Moline, IL



California Historical Society  
San Francisco, CA



Cincinnati Museum Center  
Cincinnati, OH



Conner Prairie  
Fishers, IN



First Division Museum at Cantigny  
Wheaton, IL



Florida Division of Historical Resources  
Tallahassee, FL



Hagley Museum & Library  
Wilmington, DE



Historic Ford Estates  
Grosse Pointe Shores, MI



Historic House Trust of New York City  
New York, NY





Historic New England  
Boston, MA



History Colorado  
Denver, CO



History Nebraska  
Lincoln, NE



Idaho State Historical Society  
Boise, ID



Indiana Historical Society  
Indianapolis, IN



Kentucky Historical Society  
Frankfort, KY



Maryland National Capital Park & Planning Commission  
Marlboro, MD



Massachusetts Historical Society  
Boston, MA



Michigan History Center  
Lansing, MI



Minnesota Historical Society  
St. Paul, MN



Museum of History and Industry  
Seattle, WA



Nantucket Historical Association  
Nantucket, MA



National Trust for Historic Preservation  
Washington, DC



North Carolina Office of Archives and History  
Raleigh, NC



Ohio History Connection  
Columbus, OH



Old Sturbridge Village  
Sturbridge, MA



Patapsco Heritage Greenway  
Ellicott City, MD



Pennsylvania Historical & Museum Commission  
Harrisburg, PA



Scottish Rite Masonic Museum & Library  
Lexington, MA



Senator John Heinz History Center  
Pittsburgh, PA



The Sixth Floor Museum at Dealey Plaza  
Dallas, TX



Strawbery Banke Museum  
Portsmouth, NH



The Strong  
Rochester, NY



Tennessee State Museum  
Nashville, TN



Virginia Historical Society  
Richmond, VA



Wisconsin Historical Society  
Madison, WI



Wyoming Department of State Parks and Cultural Resources  
Cheyenne, WY

Thank you for your support  
as we continue to grow!



# CONGRATULATIONS

## TO THE 2018 LEADERSHIP IN HISTORY AWARD WINNERS

### THE ALBERT B. COREY AWARD

Museum of the American Military Family and Learning Center, Tijeras, NM, in honor of their project *INSIDE OUT: Memories from Inside the Closet*

### ALABAMA

Caroline Marshall Draughon Center for the Arts and Humanities, Auburn University for the exhibit *Remembering the Great War: Alabama and World War One*

### ALASKA

Atwood Resource Center at the Anchorage Museum for the *AFN Photo Identification Project\**

### ARIZONA

Arizona Historical Society's Pioneer Museum for the exhibit *Todos Unidos: The Hispanic Experience in Flagstaff*

Chandler Museum for the project *Un-American: Engaging Our Community with the Story of Japanese Internment*

### CONNECTICUT

Connecticut Historical Society for the exhibit *Language, Culture, Communities: 200 Years of Impact by the American School for the Deaf*

Connecticut Trust for Historic Preservation for the project *Mills: Making Places of Connecticut*

Fairfield Museum and History Center for the exhibit *Fairfield Museum Commons*

Harriet Beecher Stowe Center for the *Stowe House Project*

Knights of Columbus Museum for the exhibit *World War I: Beyond the Front Lines*

### GEORGIA

Georgia Historical Society for the program *Live from the Archives: Georgia in the American Revolution*

### ILLINOIS

Glencoe Historical Society for the exhibit *Glencoe in The Great War*

### INDIANA

Indiana Historical Bureau for the podcast *Talking Hoosier History*

### KANSAS

Johnson County Museum for the exhibit *Becoming Johnson County*

Kauffman Museum for the exhibit *Sorting Out Race: Examining Racial Identity and Stereotypes in Thrift Store Donations*

### MAINE

Seal Cove Auto Museum for the exhibit *Auto Wars: Then & Now*

### MASSACHUSETTS

Duxbury Rural and Historical Society for the project *Re-imagine Bradford*

Pocumtuck Valley Memorial Association for the project *Impressions from a Lost World*

### MICHIGAN

Detroit Historical Society for the exhibit *Detroit '67: Looking Back to Move Forward\**

### MINNESOTA

Brown County Historical Society for the exhibit *Loyalty and Dissent: Brown County and WWI*

Goodhue County Historical Society and Frederick L. Johnson for the publication *Patriot Hearts: World War I Passion and Prejudice in a Minnesota County*

Marcia G. Anderson for the publication *A Bag Worth a Pony: The Art of the Ojibwe Bandolier Bag*

Minnesota Discovery Center for the exhibit *Blue-Collar Battleground: The Iron Range Labor Story*

### MISSISSIPPI

Mississippi Civil Rights Museum for their permanent exhibits

### MISSOURI

Kansas City PBS and Libraries of Greater Kansas City for the project *KC Stories of the Vietnam War*

Missouri Historical Society for the project *#1 in Civil Rights: The African American Freedom Struggle in St. Louis*

The National Museum of Toys and Miniatures for the exhibit *Playing for Keeps: The VFW Marble Tournaments, 1947-1962*

### MONTANA

Montana Historical Society for the exhibit *Big Game, Big Stories: Montana's Hunting Heritage* and for the project *Montana's African American Heritage Resources*

### NEBRASKA

Nick Batter and Ben Bohall for the podcast *Neglecta*

### NEW JERSEY

Maxine N. Lurie and Richard F. Veit for the publication *Envisioning New Jersey: An Illustrated History of the Garden State*

### NEW MEXICO

Cordelia Thomas Snow for her contributions to the preservation of the history of Santa Fe and New Mexico

Coronado Historic Site and the Friends of Coronado Historic Site for the public program *Dig Kuaua*

Silver City Museum for the program *50 Years Ago in Silver City*

### NEW YORK

Boston Historical Society for the *Living History Day* program

Leo P. Ostebo for the founding and leadership of the Leo P. Ostebo Kings Park Heritage Museum

Richard Longstreth for the publication *A Guide to Architecture in the Adirondacks*

### PENNSYLVANIA

Museum of the American Revolution for their permanent exhibits

### TENNESSEE

Andrew Jackson's Hermitage for the program *Duel! Art of the Southern Gentleman*

### UTAH

Utah Humanities for "*The Way We Worked*" *Utah Tour Project*

### VIRGINIA

James Madison's Montpelier for the exhibit *The Mere Distinction of Colour\**

### WISCONSIN

The Neville Public Museum of Brown County for the exhibit *Estamos Aquí: Celebrating Latino Identity in Northeast Wisconsin*

Oshkosh Public Museum for the exhibit *People of the Waters*

\*Recipient of a HIP (History in Progress) Award

# 2018 ANNUAL MEETING

## SCHOLARSHIP/FELLOWSHIP WINNERS

Congratulations to the following winners of a scholarship or fellowship to this year's conference:

### 2018 KANSAS CITY DIVERSITY FELLOWSHIPS

Sponsored by the William T. Kemper Foundation

*Given by the 2018 Host Committee to applicants who expand the diversity of the conference in areas such as ethnicity, gender, age, sexual orientation, socioeconomic status, and organizational capacity*

**Andrew Albertson**

Museum of Indian Arts and Culture  
Santa Fe, NM

**David Allison**

Denver Museum of Nature & Science  
Westminster, CO

**Marissa Baum**

American Jazz Museum  
Kansas City, MO

**Samantha Bieler**

Sioux City Railroad Museum  
Whiting, IA

**Sarah Carlson**

Iowa Jewish Historical Society  
Waukee, IA

**Sena Dawes**

Missouri Historical Society  
St Louis, MO

**Marla Day**

K-State Historic Costume and Textile  
Museum  
Manhattan, KS

**Sandra Enriquez**

University of Missouri-Kansas City  
Kansas City, MO

**Michael Grauer**

National Cowboy Western Heritage  
Museum  
Oklahoma City, OK

**Andrew Gustafson**

Johnson County Museum  
Overland Park, KS

**Katherine Haskel**

Paul Quinn College  
Dallas, TX

**Molly Hutson**

Overland Park Historical Society  
Overland Park, KS

**Dorris Lee Keeven-Franke**

Missouri Germans Consortium  
St. Charles, MO

**Brandice Nelson**

Texas General Land Office  
Austin, TX

**Aimee Newell**

Luzerne County Historical Society  
Wilkes-Barre, PA

**Sandy Randel**

Cherokee Strip Land Rush Museum  
Arkansas City, KS

**Katie Raney**

Texas Parks and Wildlife Dept  
Bastrop, TX

**Laura Rose**

Mormon Island State Recreation Area  
Saint Paul, NE

**Judy Rose**

Doctoral Candidate at Texas Tech  
University  
Belton, TX

**Ruth Ann Rugg**

Coalition of State Museum Associations  
Fort Worth, TX

**Megan Christine Sothan**

Gage County Historical Society  
Steele City, NE

**Nathaniel Thomas**

Clinton Foundation  
Little Rock, AR

**William Tollerton**

Vernon County Historical Society  
Nevada, MO

**Amanda Vance**

Texas City Museum  
Texas City, TX

**Lynn Ward**

Kenneth Spencer Research Library  
Lawrence, KS

**Lindsey Young**

History Museum on the Square  
Springfield, MO

### DOUGLAS EVELYN SCHOLARSHIP FOR DIVERSITY

*Given by AASLH to increase culturally diverse participation at the AASLH Annual Meeting*

**Petra Alsoofy**

Arab American National Museum  
Dearborn, MI

**Alyssa Jones**

Blythewood Historical Society and  
Museum  
Ridgeway, SC

**Berlin Loa**

Independent Contractor  
Grover Beach, CA

**Stephanie Lampkin**

Science History Institute  
Philadelphia, PA

### AASLH SMALL MUSEUM SCHOLARSHIP

*Given by the AASLH Small Museums Committee to AASLH members who are full-time, part-time, paid, or volunteer employees of small museums.*

**Cora Arney**

Delhi Historical Society  
Cincinnati, OH

**Lynne Calamia**

Arch Street Meeting House  
Philadelphia, PA

**Rebecca Dickman**

Amana Heritage Society  
Cedar Rapids, IA

**Dulce Kersting-Lark**

Latah County Historical Society  
Moscow, ID

**Lori Osborne**

Frances Willard House Museum  
Evanston, IL

### AASLH SMALL MUSEUM SCHOLARSHIP-ONLINE CONFERENCE

**Kristen Elford**

Richmond Museum of History  
Richmond, CA

**Sara Evenson**

Chenango County Historical Society  
Norwich, NY

**Mark Kratzner**

Red Skelton Museum of American  
Comedy  
Vincennes, IN

**Kenny Libben**

Cleo Redd Fisher Museum  
Loudonville, OH

**Deb Mitchell**

Museums Association of Montana  
Helena, MT

**Iliana Morton**

Camron-Stanford House and Cohen Bray  
House  
Oakland, CA

**Laura Rose**

Nebraska Game and Parks Commission  
Saint Paul, NE

**William P. Shannon IV**

St. Clair County Historical Society  
Belleville, IL

**Megan Wozniak**

Glen Ellyn Historical Society  
Glen Ellyn, IL

# Collection **Perfection**



HistoryIT™ delivers a web-based software platform that lets you manage, store and share your digital collections. With no hidden fees and a user-friendly interface, it's the easy, affordable way to achieve Collection Perfection!

**Sign up at AASLH, and pay no fees to migrate your digital collection!\***

HISTORY **IT**  
WE GIVE HISTORY A **FUTURE**

\*some restrictions apply